

Werkzeugnis



Produkt: Rohrkabelschuhe, Normalausführung
Isolation: PA (3 KV 50 Hz bzw. 2 KV 400 Hz)
Artikel-Nr.: K 416505 – K 417320
Werkstoff: galv. Sn, Cu-ETP
(Cu-ETP gemäß EN 13600)
Bemerkung: RoHS-konform (EU-Richtlinie 2002/95/EC)
Kennfarbe der Isolierhülse entspricht
der Kennfarbe des Querschnittbereichs

Eisenacher
Qualitätsmanagement



Rohrkabelschuhe

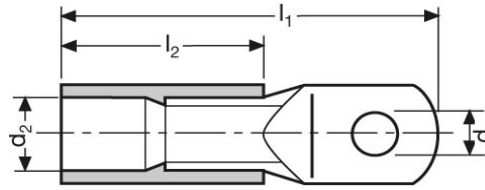

mm ²	Farbe	AWG	Nenngröße	Artikel-Nummer	Abmessung (mm)				~kg 1000 St.		VE
					d1	l1	l2	d2	Cu	Total	
6 – 10	rot	6	5 – 10	K 416505	5,5	35,5	17,0	7,0	0,520	0,570	100
			6 – 10	K 416506	6,5	35,5	17,0	7,0	0,510	0,560	100
			8 – 10	K 416508	8,5	42,0	17,0	7,0	0,600	0,650	100
			10 – 10	K 416510	10,5	46,0	17,0	7,0	0,640	0,690	100
			12 – 10	K 416512	13,0	49,0	17,0	7,0	0,660	0,710	100
10 – 16	blau	5	5 – 16	K 416605	5,5	39,5	21,0	8,5	0,860	0,910	100
			6 – 16	K 416606	6,5	41,3	21,0	8,5	0,890	0,940	100
			8 – 16	K 416608	8,5	45,5	21,0	8,5	0,950	1,000	100
			10 – 16	K 416610	10,5	49,5	21,0	8,5	1,020	1,070	100
			12 – 16	K 416612	13,0	54,0	21,0	8,5	1,100	1,150	100
16 – 25	gelb	10	5 – 25	K 416705	5,5	45,0	24,0	10,0	1,230	1,330	100
			6 – 25	K 416706	6,5	46,5	24,0	10,0	1,200	1,300	100
			8 – 25	K 416708	8,5	51,0	24,0	10,0	1,320	1,420	100
			10 – 25	K 416710	10,5	55,0	24,0	10,0	1,420	1,520	100
			12 – 25	K 416712	13,0	57,0	24,0	10,0	1,400	1,500	100
			14 – 25	K 416714	15,0	61,5	24,0	10,0	1,500	1,600	100
25 – 35	rot	2	6 – 35	K 416806	6,5	49,5	27,0	12,0	1,850	2,000	100
			8 – 35	K 416808	8,4	54,0	27,0	12,0	2,000	2,150	100
			10 – 35	K 416810	10,5	59,0	27,0	12,0	2,150	2,300	100
			12 – 35	K 416812	13,0	61,0	27,0	12,0	2,130	2,280	100
			14 – 35	K 416814	15,0	64,5	27,0	12,0	2,220	2,370	100
			16 – 35	K 416816	17,0	68,0	27,0	12,0	2,300	2,450	100
35 – 50	blau	1/0	6 – 50	K 416906	6,5	59,0	32,0	14,0	3,000	3,200	100
			8 – 50	K 416908	8,4	59,0	32,0	14,0	2,900	3,100	100
			10 – 50	K 416910	10,5	63,0	32,0	14,0	3,100	3,300	100
			12 – 50	K 416912	13,0	68,0	32,0	14,0	3,250	3,450	100
			14 – 50	K 416914	15,0	71,5	32,0	14,0	3,320	3,520	100
			16 – 50	K 416916	17,0	77,0	32,0	14,0	3,450	3,650	100
			20 – 50	K 416920	21,0	83,5	32,0	14,0	3,400	3,600	100
50 – 70	gelb	2/0	6 – 70	K 417006	6,5	65,5	33,5	16,4	4,800	5,000	50
			8 – 70	K 417008	8,5	65,5	33,5	16,4	4,500	4,700	50
			10 – 70	K 417010	10,5	66,5	33,5	16,4	4,600	4,800	50
			12 – 70	K 417012	13,0	70,5	33,5	16,4	4,660	4,860	50
			14 – 70	K 417014	15,0	73,5	33,5	16,4	4,800	5,000	50
			16 – 70	K 417016	17,0	78,5	33,5	16,4	5,100	5,300	50
			20 – 70	K 417020	21,0	84,5	33,5	16,4	5,150	5,350	50
70 – 95	rot	3/0	8 – 95	K 417108	8,5	74,0	40,0	17,8	5,700	6,050	25
			10 – 95	K 417110	10,5	74,0	40,0	17,8	5,550	5,900	25
			12 – 95	K 417112	13,0	76,0	40,0	17,8	5,600	5,950	25
			14 – 95	K 417114	15,0	79,5	40,0	17,8	5,800	6,150	25
			16 – 95	K 417116	17,0	84,0	40,0	17,8	6,000	6,350	25
			20 – 95	K 417120	21,0	96,0	40,0	17,8	6,900	7,250	25

95 – 120	blau	4/0	8 – 120	K 417208	8,5	80,5	41,5	19,3	6,800	7,200	25
			10 – 120	K 417210	10,5	80,5	41,5	19,3	6,650	7,050	25
			12 – 120	K 417212	13,0	80,5	41,5	19,3	6,450	6,850	25
			14 – 120	K 417214	15,0	82,5	41,5	19,3	6,550	6,950	25
			16 – 120	K 417216	17,0	85,5	41,5	19,3	6,600	7,000	25
			20 – 120	K 417220	20,0	100,5	41,5	19,3	7,900	8,300	25
120 – 150	gelb	5/0	8 – 150	K 417308	8,5	88,0	48,0	20,8	7,930	8,430	25
			10 – 150	K 417310	10,5	88,0	48,0	20,8	7,900	8,400	25
			12 – 150	K 417312	13,0	89,0	48,0	20,8	7,850	8,350	25
			14 – 150	K 417314	15,0	90,0	48,0	20,8	7,750	8,250	25
			16 – 150	K 417316	17,0	92,0	48,0	20,8	7,700	8,200	25
			20 – 150	K 417320	21,0	106,0	48,0	20,8	9,000	9,500	25