

Werkzeugnis



Produkt: AL-Presskabelschuhe, längsdicht
zum Anschluss an Schienen (Innenraum)

Oberfläche: - blank
- wahlweise verzinkt: 3 - 5 µm

Artikel-Nr.: K 3302008 – K 3303220

Norm: DIN 46329

Werkstoff: Al 99,5

Bemerkung: RoHS-konform (EU-Richtlinie 2002/95/EC)

Eisenacher
Qualitätsmanagement



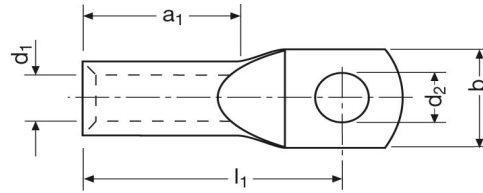

AL – Presskabelschuhe

Nennquerschnitt mm ²		Kenn- ziffer	Nenn- größe	Artikel- Nummer	Abmessung (mm)					~kg 1000 St.	VE
rm / sm	se				d1	d2	b	l	a		
16	25	12	8 – 16	K 3302008	5,8	8,4	20,0	50,0	30,0	14,1	100
			10 – 16	K 3302010	5,8	10,5	20,0	50,0	30,0	12,8	100
25	35	12	8 – 25	K 3302108	6,8	8,4	20,0	50,0	30,0	12,6	100
			10 – 25	K 3302110	6,8	10,5	25,0	50,0	30,0	13,2	100
			12 – 25	K 3302112	6,8	13,0	25,0	50,0	30,0	12,8	100
35	50	14	8 – 35	K 3302208	8,0	8,4	25,0	62,0	42,0	21,4	100
			10 – 35	K 3302210	8,0	10,5	25,0	62,0	42,0	21,4	100
			12 – 35	K 3302212	8,0	13,0	25,0	62,0	42,0	21,4	100
50	70	16	8 – 50	K 3302308	9,8	8,4	25,0	62,0	42,0	27,6	50
			10 – 50	K 3302310	9,8	10,5	25,0	62,0	42,0	27,3	50
			12 – 50	K 3302312	9,8	13,0	25,0	62,0	42,0	25,8	50
70	95	18	8 – 70	K 3302408	11,2	8,4	25,0	72,0	52,0	39,0	50
			10 – 70	K 3302410	11,2	10,5	25,0	72,0	52,0	39,6	50
			12 – 70	K 3302412	11,2	13,0	25,0	72,0	52,0	38,5	50
95	120	22	10 – 95	K 3302510	13,2	10,5	25,0	75,0	56,0	54,1	25
			12 – 95	K 3302512	13,2	13,0	25,0	75,0	56,0	53,2	25
			16 – 95	K 3302516	13,2	17,0	25,0	75,0	56,0	58,3	25
120	150	22	10 – 120	K 3302610	14,7	10,5	30,0	80,0	56,0	67,2	25
			12 – 120	K 3302612	14,7	13,0	30,0	80,0	56,0	64,2	25
			16 – 120	K 3302616	14,7	17,0	30,0	80,0	56,0	60,4	25
150	185	25	10 – 150	K 3302710	16,3	10,5	30,0	90,0	60,0	81,8	25
			12 – 150	K 3302712	16,3	13,0	30,0	90,0	60,0	83,0	25
			16 – 150	K 3302716	16,3	17,0	30,0	90,0	60,0	80,0	25
			20 – 150	K 3302720	16,3	21,0	30,0	90,0	60,0	89,5	25
185	240	28	10 – 185	K 3302810	18,3	10,5	30,0	91,0	60,0	111,0	20
			12 – 185	K 3302812	18,3	13,0	30,0	91,0	60,0	107,0	20
			16 – 185	K 3302816	18,3	17,0	30,0	91,0	60,0	105,0	20
			20 – 185	K 3302820	18,3	21,0	30,0	91,0	60,0	100,0	20
240	300	32	10 – 240	K 3302910	21,0	10,5	38,0	103,0	70,0	165,0	15
			12 – 240	K 3302912	21,0	13,0	38,0	103,0	70,0	166,5	15
			16 – 240	K 3302916	21,0	17,0	38,0	103,0	70,0	167,0	15
			20 – 240	K 3302920	21,0	21,0	38,0	103,0	70,0	159,0	15
300		34	12 – 300	K 3303012	23,3	13,0	38,0	103,0	70,0	173,5	10
			16 – 300	K 3303016	23,3	17,0	38,0	103,0	70,0	172,8	10
			20 – 300	K 3303020	23,3	21,0	38,0	103,0	70,0	172,4	10
400		38	12 – 400	K 3303112	26,0	13,0	38,0	116,0	73,0	264,9	5
			16 – 400	K 3303116	26,0	17,0	38,0	116,0	73,0	267,0	5
			20 – 400	K 3303120	26,0	21,0	38,0	116,0	73,0	261,0	5
500		44	12 – 500	K 3303212	29,0	13,0	44,0	122,0	79,0	379,5	5
			16 – 500	K 3303216	29,0	17,0	44,0	122,0	79,0	378,0	5
			20 – 500	K 3303220	29,0	21,0	44,0	122,0	79,0	369,8	5
		rm	=	round stranded							
		sm	=	sector stranded							
		se	=	sector solid							