

Werkzeugnis



Produkt: Presskabelschuh
Oberfläche: - galv. verzinkt: 3 - 5 µm
- wahlweise blank
Artikel-Nr.: K 3135050 – K 3152200
Norm: DIN 46235
Werkstoff: Cu-ETP Rohr gemäß EN 13600
Bemerkung: RoHS-konform (EU-Richtlinie 2002/95/EC)

Eisenacher
Qualitätsmanagement



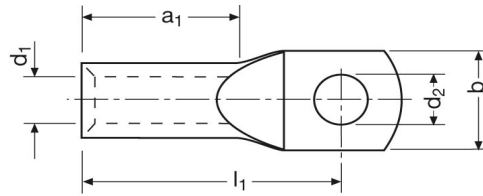

Presskabelschuhe

mm ²	Kenn- ziffer	Nenn- größe	Artikel- Nummer	Abmessung (mm)						~kg 1000 St.	VE
				d2	b	l	a	d3	d1		
6	5	5 - 6	K 3135050	5,3	8,5	24,0	10,0	5,5	3,8	3,5	100
		6 - 6	K 3135060	6,4	8,5	24,0	10,0	5,5	3,8	3,5	100
10	6	5 - 10	K 3136050	5,3	9,0	27,0	10,0	6,0	4,5	3,9	100
		6 - 10	K 3136060	6,4	9,0	27,0	10,0	6,0	4,5	3,9	100
16	8	6 - 16	K 3137060	6,4	13,0	36,0	20,0	8,5	5,5	11,8	100
		8 - 16	K 3137080	8,4	13,0	36,0	20,0	8,5	5,5	11,8	100
		10 - 16	K 3137100	10,5	17,0	36,0	20,0	8,5	5,5	12,0	100
		12 - 16	K 3137120	13,0	18,0	36,0	20,0	8,5	5,5	11,8	100
25	10	6 - 25	K 3138060	6,4	14,0	38,0	20,0	10,0	7,0	14,9	100
		8 - 25	K 3138080	8,4	16,0	38,0	20,0	10,0	7,0	15,7	100
		10 - 25	K 3138100	10,5	17,0	38,0	20,0	10,0	7,0	15,8	100
		12 - 25	K 3138120	13,0	19,0	38,0	20,0	10,0	7,0	15,4	100
35	12	8 - 35	K 3139080	8,4	17,0	42,0	20,0	12,5	8,2	28,0	100
		10 - 35	K 3139100	10,5	19,0	42,0	20,0	12,5	8,2	27,0	100
		12 - 35	K 3139120	13,0	21,0	42,0	20,0	12,5	8,2	28,5	100
50	14	8 - 50	K 3140080	8,4	20,0	52,0	28,0	14,5	10,0	45,0	100
		10 - 50	K 3140100	10,5	22,0	52,0	28,0	14,5	10,0	45,0	100
		12 - 50	K 3140120	13,0	24,0	52,0	28,0	14,5	10,0	44,5	100
		16 - 50	K 3140160	17,0	28,0	52,0	28,0	14,5	10,0	45,0	100
70	16	8 - 70	K 3141080	8,4	24,0	55,0	28,0	16,5	11,5	60,5	50
		10 - 70	K 3141100	10,5	24,0	55,0	28,0	16,5	11,5	61,5	50
		12 - 70	K 3141120	13,0	24,0	55,0	28,0	16,5	11,5	59,0	50
		16 - 70	K 3141160	17,0	30,0	55,0	28,0	16,5	11,5	59,0	50
95	18	10 - 95	K 3142100	10,5	28,0	65,0	35,0	19,0	13,5	92,5	50
		12 - 95	K 3142120	13,0	28,0	65,0	35,0	19,0	13,5	91,5	50
		16 - 95	K 3142160	17,0	32,0	65,0	35,0	19,0	13,5	90,0	50
120	20	10 - 120	K 3143100	10,5	32,0	70,0	35,0	21,0	15,5	114,0	50
		12 - 120	K 3143120	13,0	32,0	70,0	35,0	21,0	15,5	114,0	50
		16 - 120	K 3143160	17,0	32,0	70,0	35,0	21,0	15,5	113,0	50
		20 - 120	K 3143200	21,0	38,0	70,0	35,0	21,0	15,5	112,0	50
150	22	10 - 150	K 3144100	10,5	34,0	78,0	35,0	23,5	17,0	164,0	25
		12 - 150	K 3144120	13,0	34,0	78,0	35,0	23,5	17,0	163,0	25
		16 - 150	K 3144160	17,0	34,0	78,0	35,0	23,5	17,0	162,0	25
		20 - 150	K 3144200	21,0	40,0	78,0	35,0	23,5	17,0	160,0	25
185	25	10 - 185	K 3145100	10,5	37,0	82,0	40,0	25,5	19,0	19,3	25
		12 - 185	K 3145120	13,0	37,0	82,0	40,0	25,5	19,0	19,3	25
		16 - 185	K 3145160	17,0	37,0	82,0	40,0	25,5	19,0	19,3	25
		20 - 185	K 3145200	21,0	40,0	82,0	40,0	25,5	19,0	19,3	25
240	28	12 - 240	K 3146120	13,0	42,0	92,0	40,0	29,0	21,5	27,6	25
		16 - 240	K 3146160	17,0	42,0	92,0	40,0	29,0	21,5	27,6	25
		20 - 240	K 3146200	21,0	45,0	92,0	40,0	29,0	21,5	27,6	25
300	32	12 - 300	K 3147120	13,0	48,0	100,0	50,0	32,0	24,5	33,8	20
		16 - 300	K 3147160	17,0	48,0	100,0	50,0	32,0	24,5	33,8	20
		20 - 300	K 3147200	21,0	48,0	100,0	50,0	32,0	24,5	33,8	20

400	38	12 - 400	K 3148120	13,0	55,0	115,0	70,0	38,5	27,5	69,4	10
		16 - 400	K 3148160	17,0	55,0	115,0	70,0	38,5	27,5	69,4	10
		20 - 400	K 3148200	21,0	55,0	115,0	70,0	38,5	27,5	69,4	10
500	42	12 - 500	K 3149120	13,0	60,0	125,0	70,0	42,0	31,0	83,0	10
		16 - 500	K 3149160	17,0	60,0	125,0	70,0	42,0	31,0	83,0	10
		20 - 500	K 3149200	21,0	60,0	125,0	70,0	42,0	31,0	83,0	10
625	44	16 - 625	K 3150160	17,0	60,0	135,0	80,0	44,0	34,5	79,6	5
		20 - 625	K 3150200	21,0	60,0	135,0	80,0	44,0	34,5	79,6	5
800	52	16 - 800	K 3151160	17,0	75,0	165,0	100,0	52,0	40,0	150,2	3
		20 - 800	K 3151200	21,0	75,0	165,0	100,0	52,0	40,0	150,2	3
1000	58	16 - 1000	K 3152160	17,0	85,0	165,0	100,0	58,0	44,0	199,0	1
		20 - 1000	K 3152200	21,0	85,0	165,0	100,0	58,0	44,0	199,0	1