

# Werkzeugnis



Produkt: Lötkaabelschuhe, Ringform, unisoliert  
Oberfläche: feuerverzinkt  
Artikel-Nr.: K 3101025 – K 3110120  
Norm: DIN 46211 Form A  
Werkstoff: CuZn  
Bemerkung: RoHS-konform (EU-Richtlinie 2002/95/EC)

Eisenacher  
Qualitätsmanagement



Lötkaabelschuhe

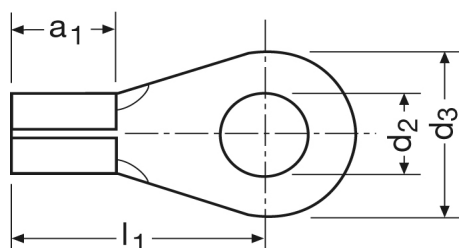

mm <sup>2</sup>	Nenngröße	Artikel- Nummer	Abmessung (mm)				~kg 1000 St.	VE
			d2	d3	l1	a1		
0,5 - 1,0	2,5 - 1,0	K 3101025	2,8	5,5	9,5	3,5	0,20	10.000
	3,0 - 1,0	K 3101035	3,2	6,0	10,0	6,5	0,25	10.000
	4,0 - 1,0	K 3101040	4,3	8,0	11,5	3,5	0,32	6.000
	5,0 - 1,0	K 3101050	5,3	10,0	13,0	3,5	0,42	5.000
1,5 - 2,5	3,5 - 2,5	K 3102035	3,7	7,0	12,0	6,0	0,64	4.000
	4,0 - 2,5	K 3102040	4,3	8,0	14,5	6,0	0,90	3.000
	5,0 - 2,5	K 3102050	5,3	10,0	16,0	6,0	1,10	2.000
	6,0 - 2,5	K 3102065	6,5	11,0	17,0	6,0	1,14	2.000
	8,0 - 2,5	K 3102080	8,4	15,0	20,0	6,0	1,65	1.250
4 - 6	4,0 - 6,0	K 3103040	4,3	8,0	16,0	8,0	1,45	1.500
	5,0 - 6,0	K 3103050	5,3	10,0	18,0	8,0	1,80	1.250
	6,0 - 6,0	K 3103065	6,5	11,0	19,0	8,0	1,90	1.250
	8,0 - 6,0	K 3103080	8,4	15,0	23,0	8,0	2,70	750
	10 - 6,0	K 3103100	10,5	19,0	24,0	8,0	3,30	600
6 - 10	5,0 - 10	K 3104050	5,3	10,0	19,0	10,0	3,00	1.000
	6,0 - 10	K 3104060	6,5	11,0	21,0	10,0	3,10	750
	8,0 - 10	K 3104080	8,4	15,0	24,0	10,0	4,00	600
	10 - 10	K 3104100	10,5	19,0	26,0	10,0	4,90	400
10 - 16	6,0 - 16	K 3105060	6,5	11,0	24,0	11,5	5,10	500
	8,0 - 16	K 3105080	8,4	15,0	27,0	11,5	6,10	400
	10 - 16	K 3105100	10,5	19,0	29,0	11,5	7,30	300
	12 - 16	K 3105120	13,0	22,0	31,0	11,5	8,50	250
16 - 25	6,0 - 25	K 3106060	6,5	13,0	27,0	13,5	9,00	300
	8,0 - 25	K 3106080	8,4	15,0	30,0	13,5	10,00	250
	10 - 25	K 3106100	10,5	19,0	32,0	13,5	11,10	200
	12 - 25	K 3106120	13,0	22,0	35,0	13,5	12,50	150
25 - 35	8 - 35	K 3107080	8,4	15,0	33,0	16,0	14,50	150
	10 - 35	K 3107100	10,5	19,0	35,0	16,0	15,70	150
	12 - 35	K 3107120	13,0	22,0	38,0	16,0	17,40	125
35 - 50	8 - 50	K 3108080	8,4	17,0	36,0	19,0	23,60	100
	10 - 50	K 3108100	10,5	19,0	38,0	19,0	24,50	100
	12 - 50	K 3108120	13,0	22,0	41,0	19,0	26,70	75
50 - 70	10 - 70	K 3109100	10,5	21,0	44,0	24,0	42,50	50
	12 - 70	K 3109120	13,0	22,0	47,0	24,0	43,80	50
70 - 95	10 - 95	K 3110100	10,5	21,0	44,0	24,0	54,40	40
	12 - 95	K 3110120	13,0	22,0	47,0	24,0	55,40	40