

Quetschkabelschuhe

Ringform
16 mm² M 5

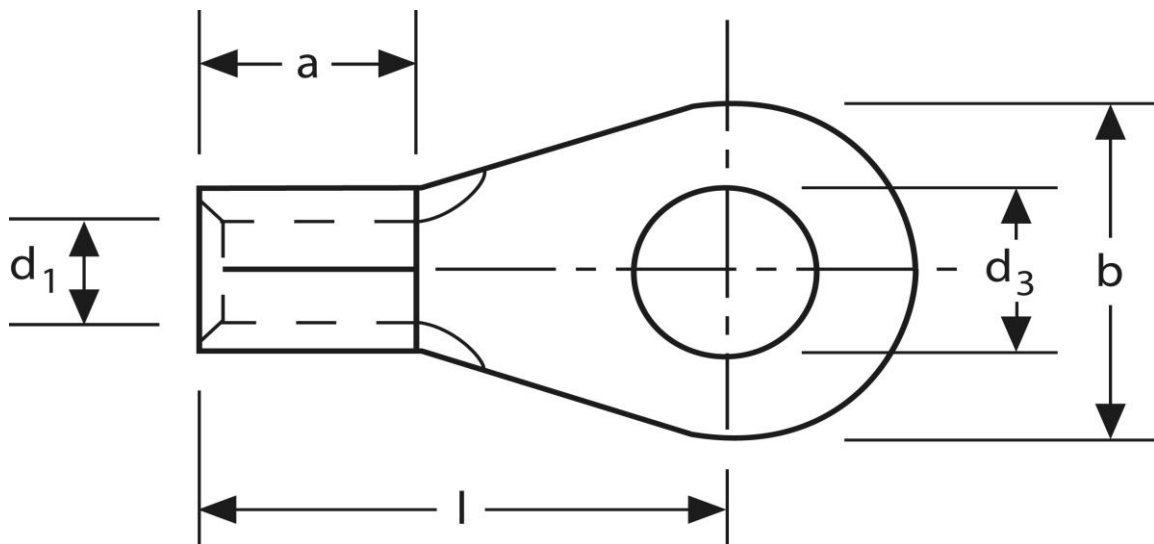

Art.Nr.	Werkstoff	Oberfläche		
K 305050.1	E-CU	galv. Sn	3,90 / 1000	600
	d ₃	d ₁	b	
in mm:	5,3	5,8	11	
	l	a	s	
in mm:	20	10	1,2	

Stand: 25.01.2019

Solderless terminals
 ring-type
 16 mm² M 5

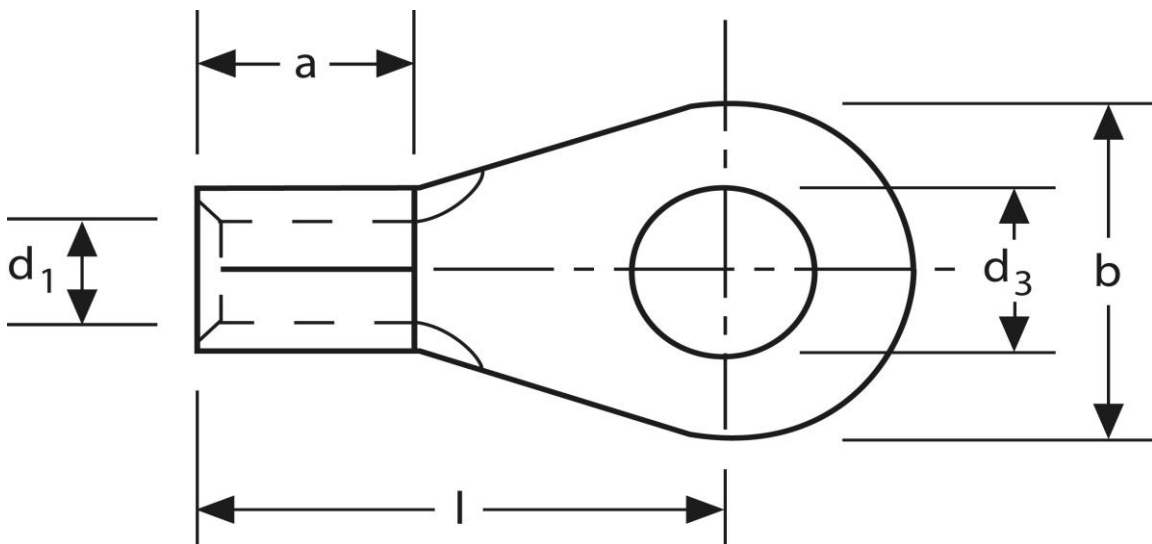

part no.	material	surface		
K 305050.1	E-CU	tin-plated	3,90 / 1000	600
	d₃	d₁	b	
in mm:	5,3	5,8	11	
	l	a	s	
in mm:	20	10	1,2	

date: 25.01.2019