

Aderendhülsen 95 mm² - 40 mm

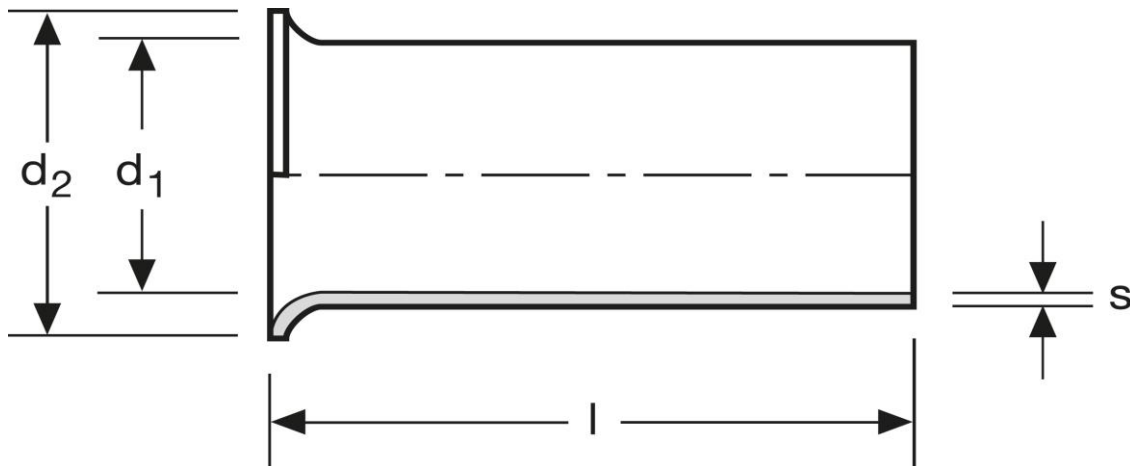

Art.Nr.	Werkstoff	Oberfläche		
A 118400	Cu-ETP	galv. Sn	6,910/1000	25
	l	d₁	d₂	s
in mm:	40	14,7	17,0	0,35

Stand: 03.01.2019

Cord end-sleeves
 95 mm² - 40 mm

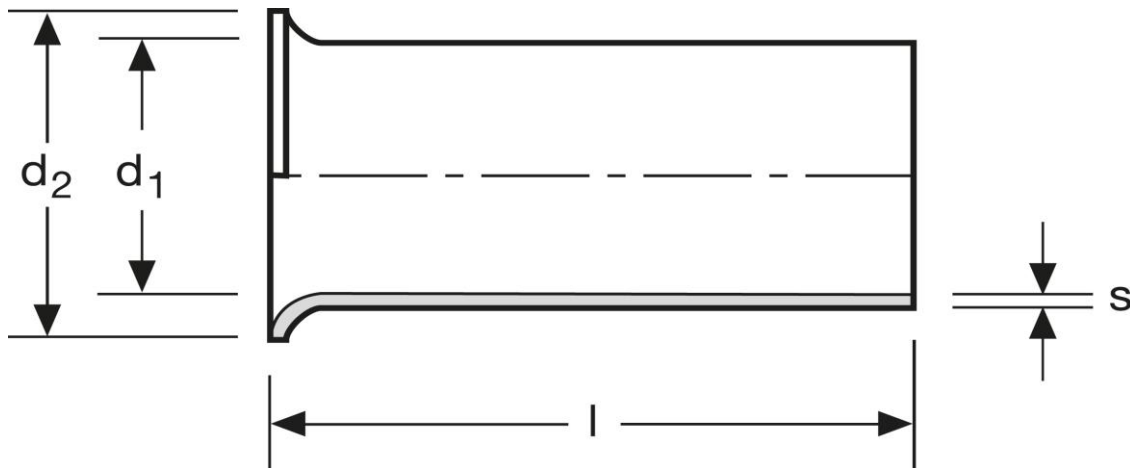

art.no.	material	surface		
A 118400	Cu-ETP	tin plated	6,910/1000	25
	l	d₁	d₂	s
in mm:	40	14,7	17,0	0,35

Date: 03.01.2019