

Aderendhülsen 10 mm² - 25 mm

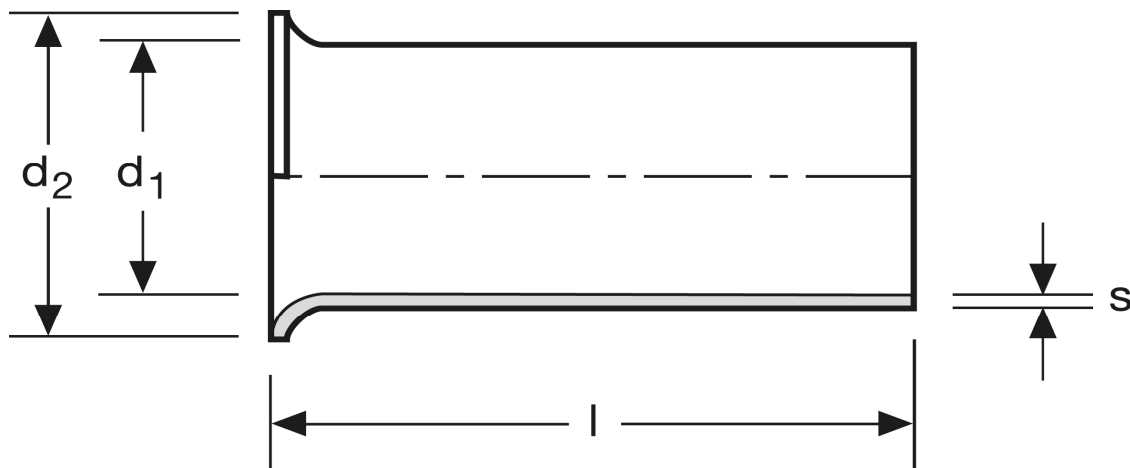

Art.Nr.	Werkstoff	Oberfläche		
A 112250	Cu-ETP	galv. Sn	0,699/1000	100
	l	d_1	d_2	s
in mm:	25	4,6	5,8	0,20

Stand: 02.07.2014

Cord end-sleeves 10 mm² - 25 mm

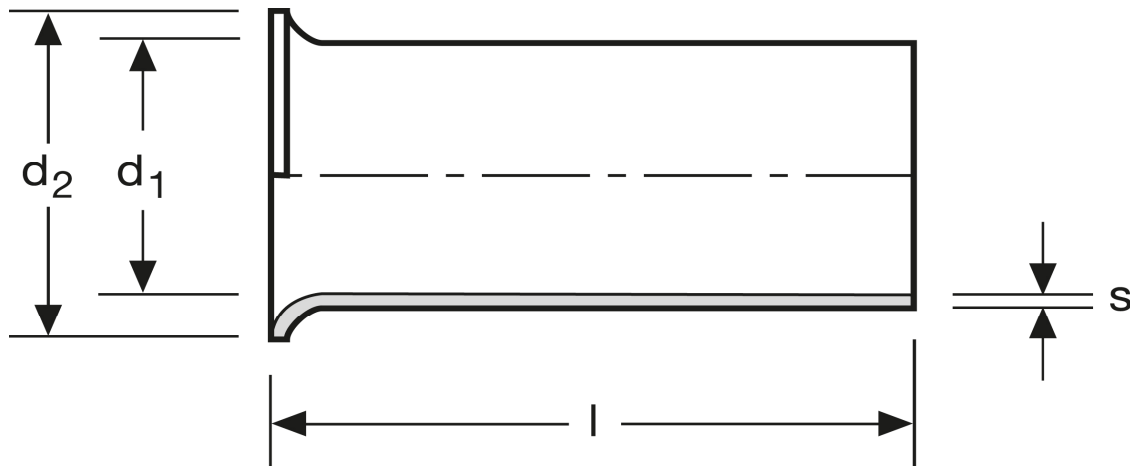

art.no.	material	surface		
A 112250	Cu-ETP	tin plated	0,699/1000	100
	l	d_1	d_2	s
in mm:	25	4,6	5,8	0,20

Date: 02.07.2014