

Aderendhülsen 6 mm² - 18 mm

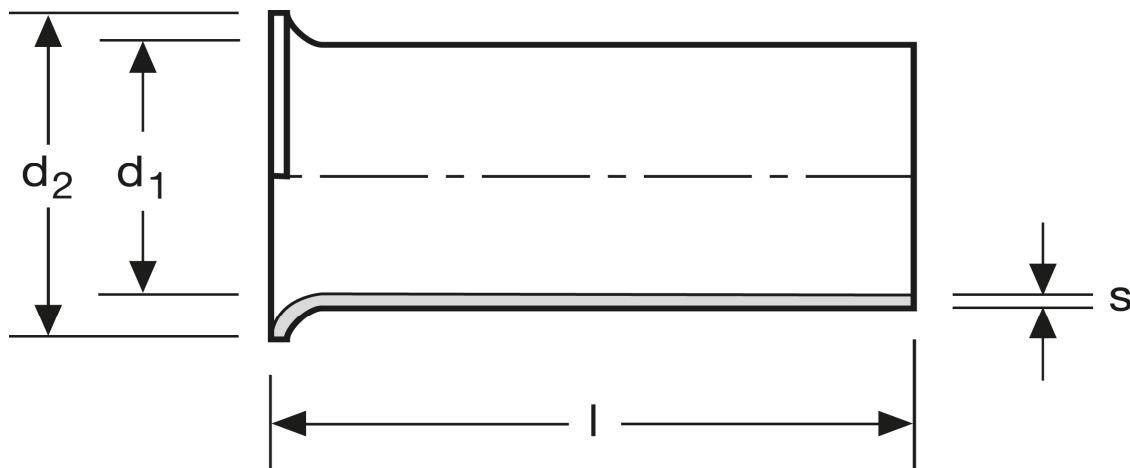

Art.Nr.	Werkstoff	Oberfläche		
A 111180	Cu-ETP	galv. Sn	0,414/1000	500
	l	d ₁	d ₂	s
in mm:	18	3,6	4,7	0,20

Stand: 01.07.2014

Cord end-sleeves

6 mm² - 18 mm

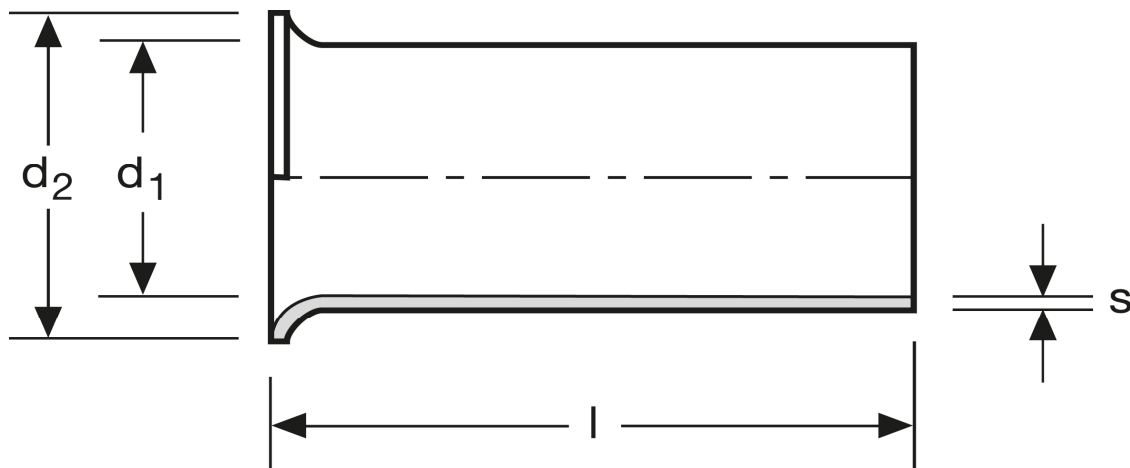

art.no.	material	surface		
A 111180	Cu-ETP	tin plated	0,414/1000	500
	l	d_1	d_2	s
in mm:	18	3,6	4,7	0,20

Date: 01.07.2014