

Aderendhülsen

0,25 mm² - 7 mm

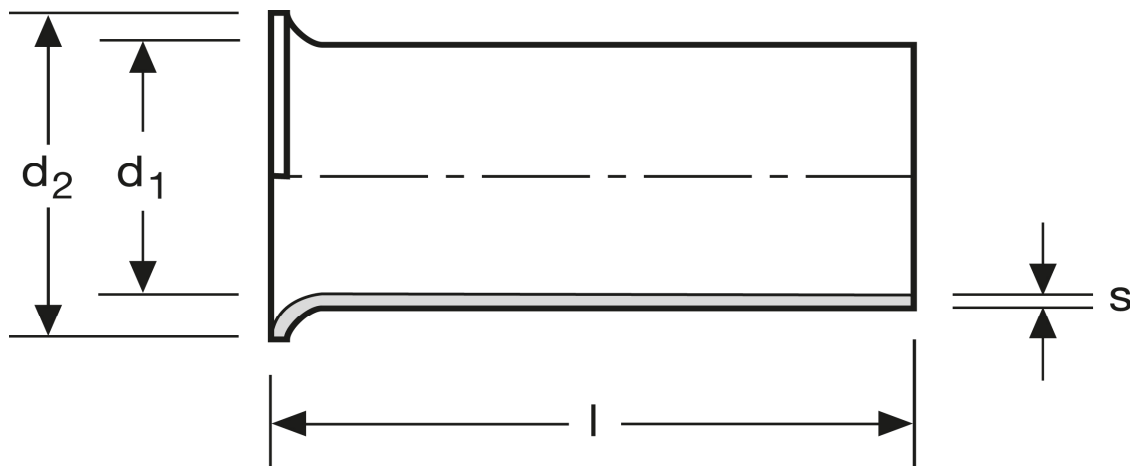

Art.Nr.	Werkstoff	Oberfläche		
A 103071	Cu-ETP	galv. Ag	0,035/1000	1.000
	l	d ₁	d ₂	s
in mm:	7	0,8	1,7	0,15

Stand: 26.06.2014

Cord end-sleeves

0,25 mm² - 7 mm

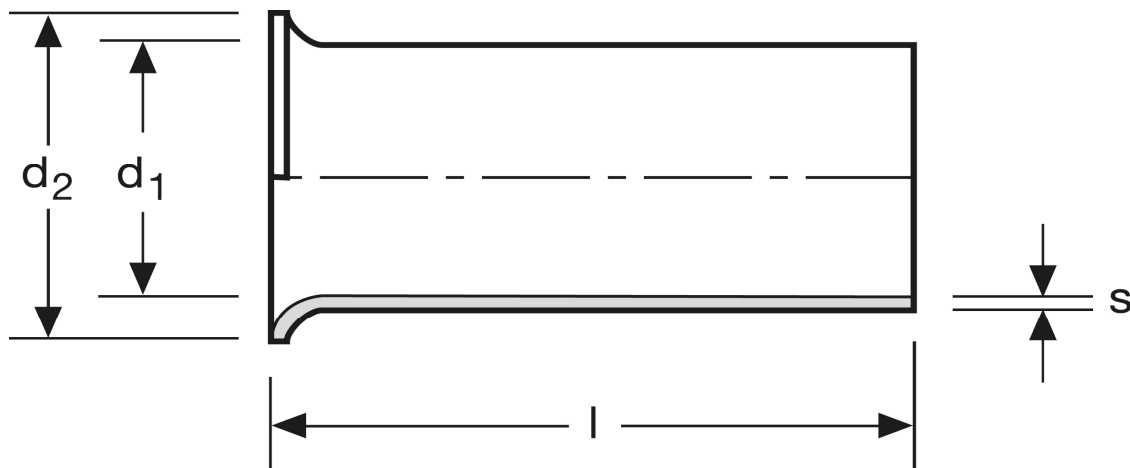

art.no.	material	surface		
A 103071	Cu-ETP	silv. plated	0,035/1000	1.000
	l	d_1	d_2	s
in mm:	7	0,8	1,7	0,15

Date: 26.06.2014