

**Al - Pressverbinder**  
 rm/sm 500 mm<sup>2</sup>

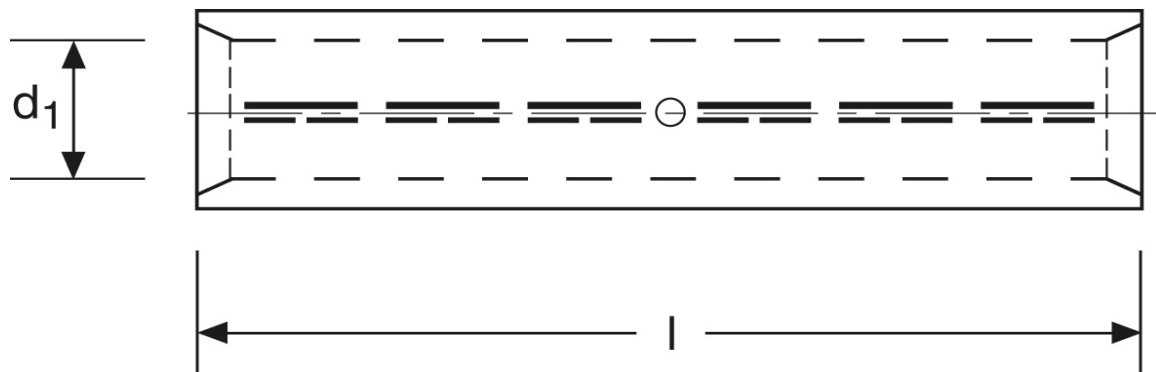

Art.Nr.	Werkstoff		
K3310500	E-Al 99,5	560,0/1000	1

	d <sub>1</sub>	l
in mm:	29,0	210

Stand: 08.08.2014

**Al - compression joints**  
 rm/sm 500 mm<sup>2</sup>

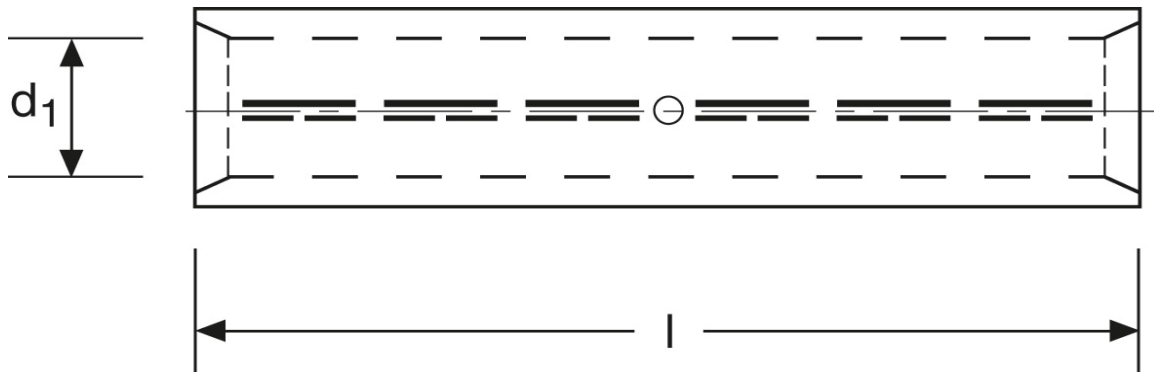

part no.	material		
K3310500	E-Al 99,5	560,0/1000	1

	d <sub>1</sub>	l
in mm:	29,0	210

date: 08.08.2014