

Al - Pressverbinder
 rm/sm 16 mm² - se 25 mm²

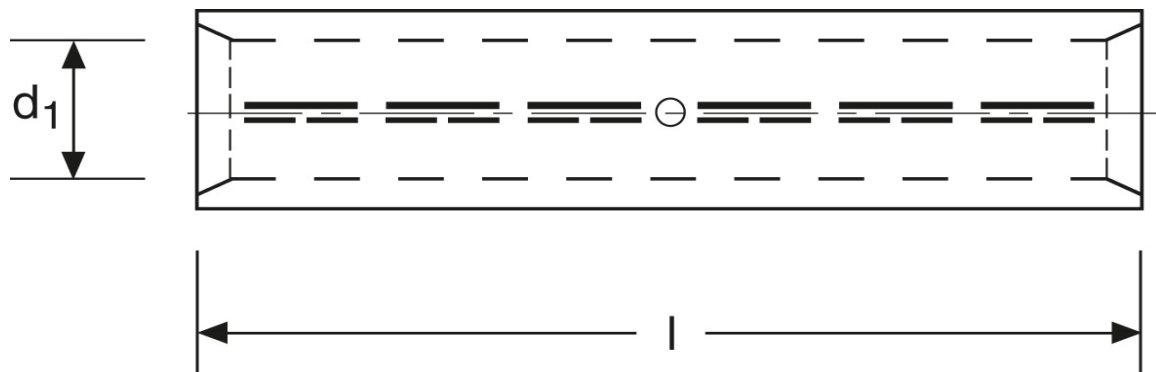

Art.Nr.	Werkstoff		
K3310016	E-Al 99,5	14,0/1000	10

	d_1	l
in mm:	5,8	55

Stand: 08.08.2014

Al - compression joints
 rm/sm 16 mm² - se 25 mm²

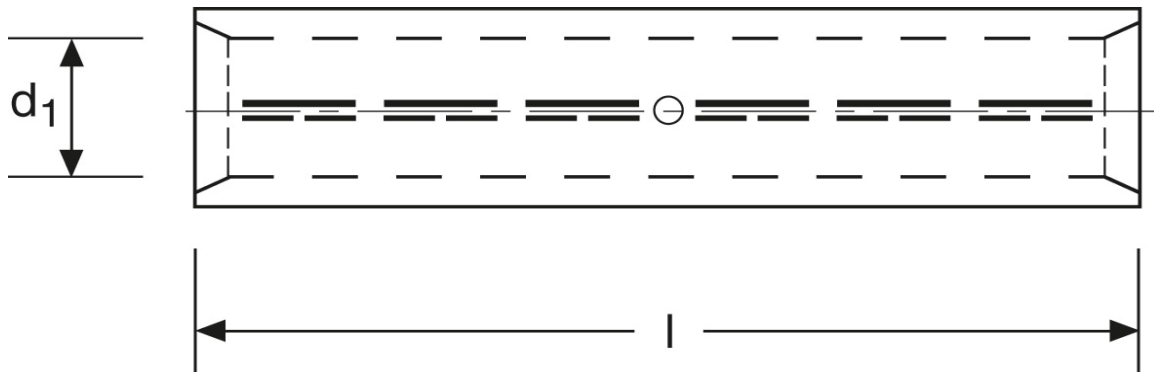

part no.	material		
K3310016	E-Al 99,5	14,0/1000	10

	d_1	l
in mm:	5,8	55

date: 08.08.2014