

Quetschkabelschuhe
Ringform - Sonderausführung
35 mm² M 6

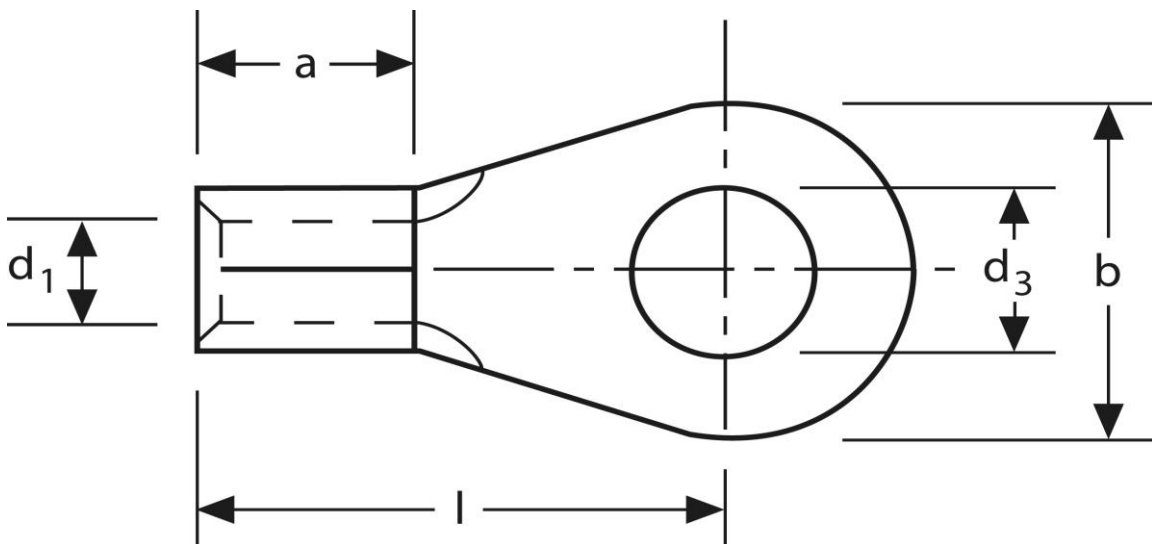

Art.Nr.	Werkstoff	Oberfläche		
K 307060.9	E-CU	galv. Sn	10,50 / 1000	200
	d ₃	d ₁	b	
in mm:	6,4	8,2	15	
	l	a	s	
in mm:	33	16,0	1,5	

Stand: 25.01.2019

Solderless terminals
ring-type
35 mm² M 6

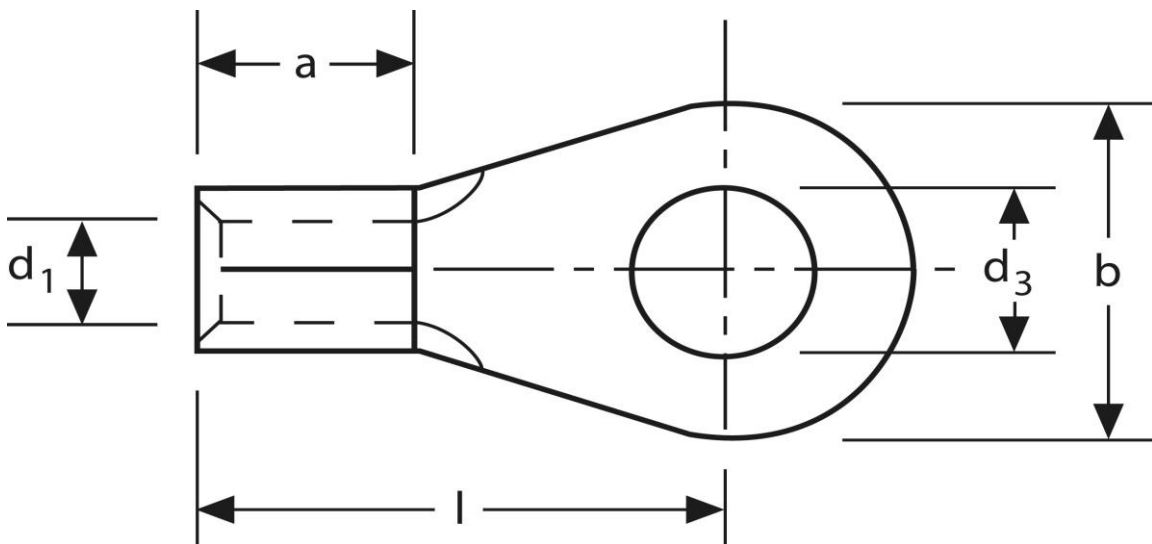

part no.	material	surface		
K 307060.9	E-CU	tin-plated	10,50 / 1000	200
	d₃	d₁	b	
in mm:	6,4	8,2	15	
	l	a	s	
in mm:	33	16,0	1,5	

date: 25.01.2019