

Quetschkabelschuhe
Ringform - Sonderausführung
16 mm² M 6

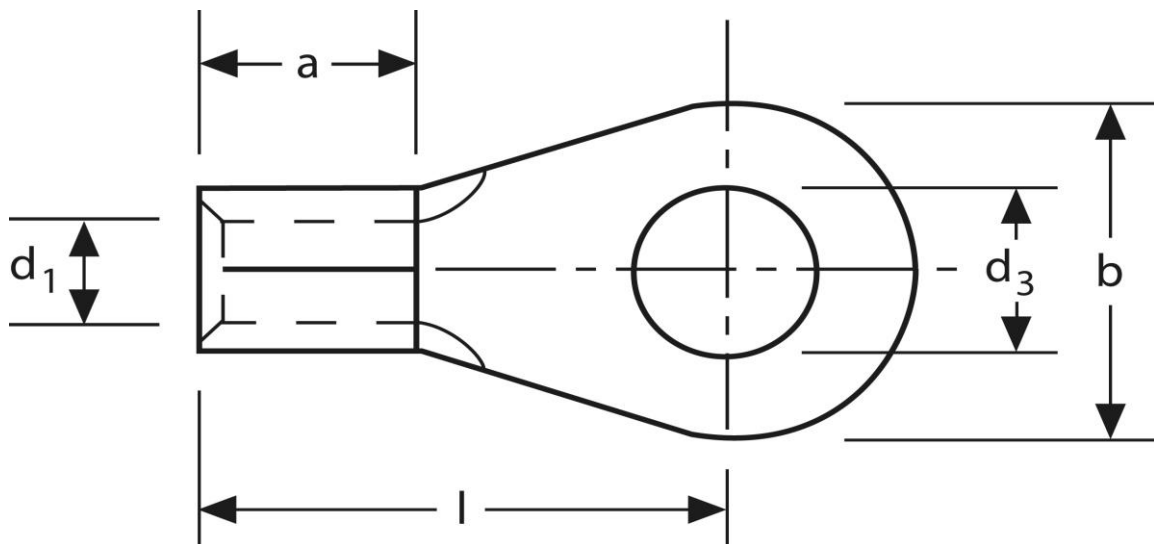

Art.Nr.	Werkstoff	Oberfläche		
K 305060.9	E-CU	galv. Sn	3,80 / 1000	600
	d ₃	d ₁	b	
in mm:	6,4	5,4	11	
	l	a	s	
in mm:	24	11,5	1,0	

Stand: 25.01.2019

Solderless terminals
ring-type
16 mm² M 6

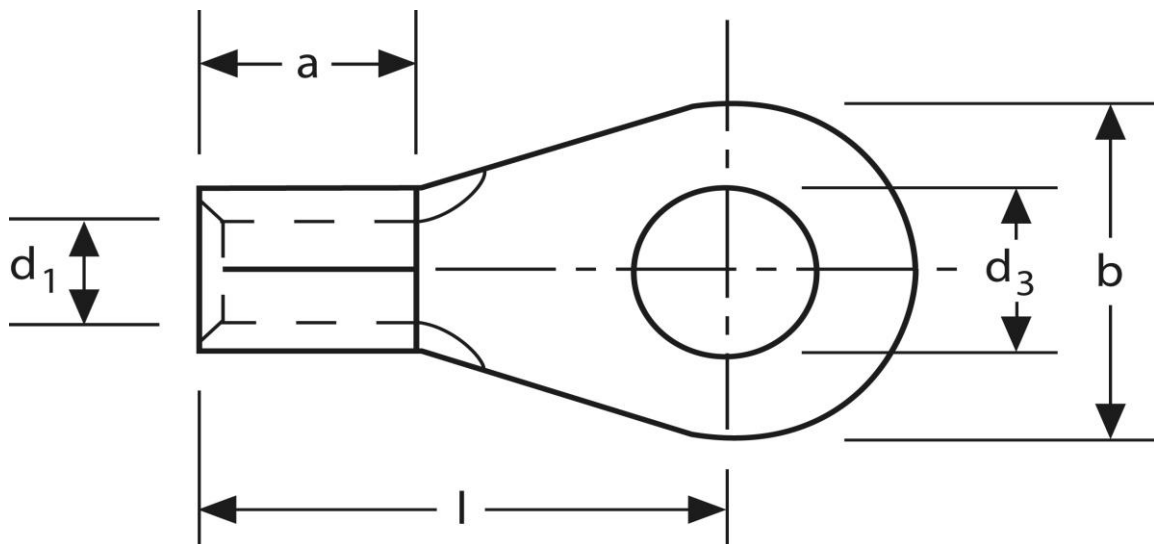

part no.	material	surface		
K 305060.9	E-CU	tin-plated	3,80 / 1000	600
	d₃	d₁	b	
in mm:	6,4	5,4	11	
	l	a	s	
in mm:	24	11,5	1,0	

date: 25.01.2019