

Quetschkabelschuhe

Ringform
6 mm² M 6

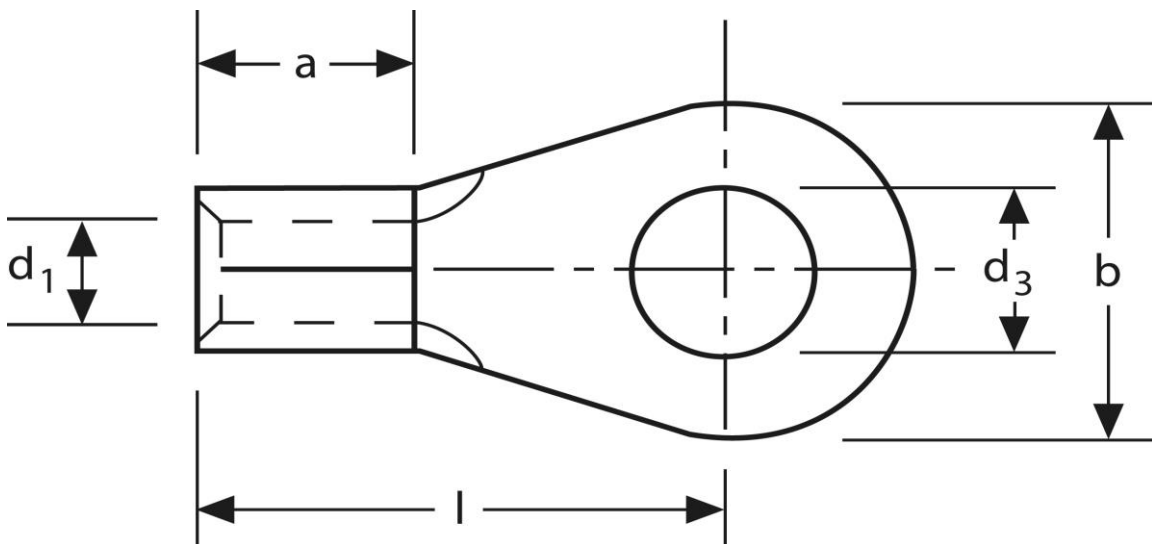



Art.Nr.	Werkstoff	Oberfläche		
K303060NTM	E-CU	galv. Sn	1,70 / 1000	1.000
	d ₃	d ₁	b	
in mm:	6,5	3,6	11	
	l	a		
in mm:	16	5		

Stand: 22.01.2019

Solderless terminals

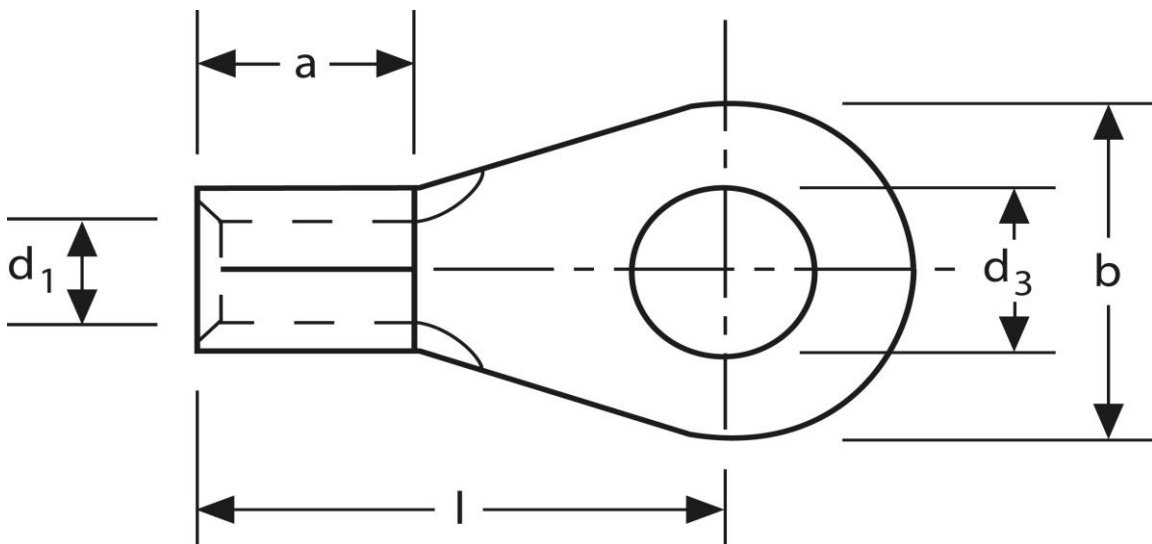
ring-type
6 mm² M 6



part no.	material	surface		
K303060NTM	E-CU	tin-plated	0,58 / 1000	1.000
	d₃	d₁	b	
in mm:	6,5	3,6	11	
	l	a		
in mm:	16	5		

date: 22.01.2019