

Flachstecker

A.W.G. 20 - 14 (ca. 0,5 - 2 mm²)

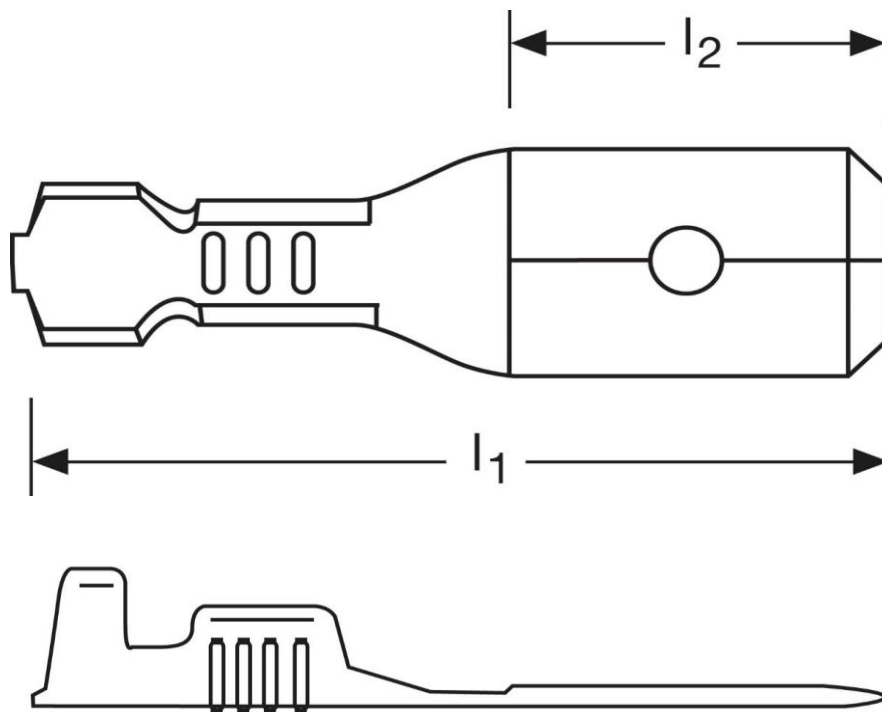

Abbildung zeigt eine verzinkte Ausführung



Art.Nr.	Werkstoff	Oberfläche	$\frac{\sigma}{\sigma_0}$	
F 507630011.1	Messing	blank	0,48/1000	500
	l_1	l_2	Steckgröße	
in mm:	20,8	11,6	6,3 - 0,8	

Stand: 25.02.2019



Male disconnects

A.W.G. 20 - 14 (ca. 0,5 - 2 mm²)

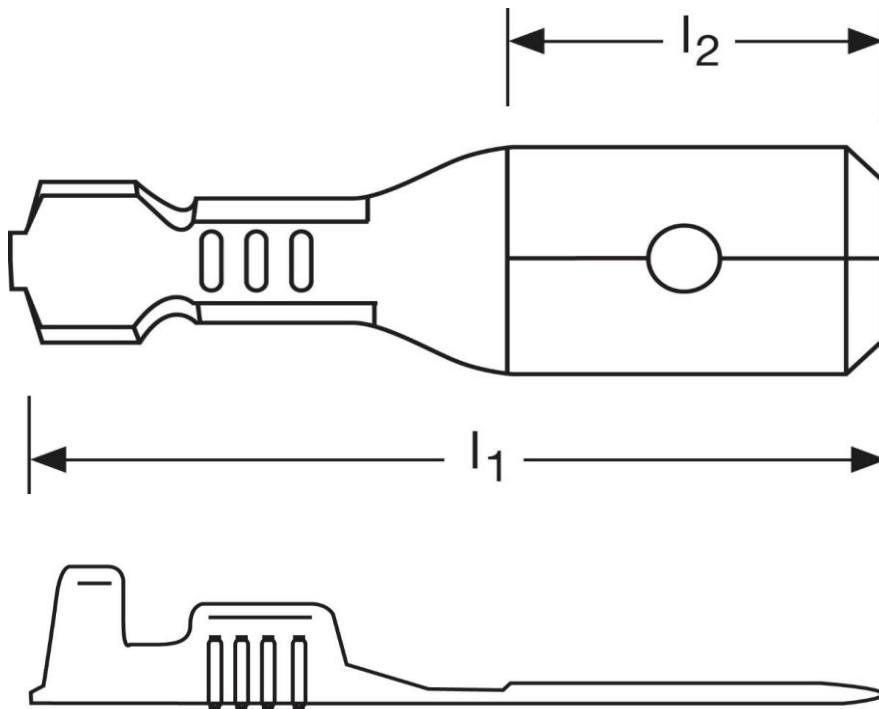

picture shows a tin-plated type

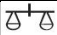

part no.	material	surface		
F 507630011.1	brass	bare	0,48/1000	500
	l_1	l_2	tab-size	
in mm:	20,8	11,6	6,3 - 0,8	

date: 25.02.2019