

Aderendhülsen 0,5 mm² - 6 mm

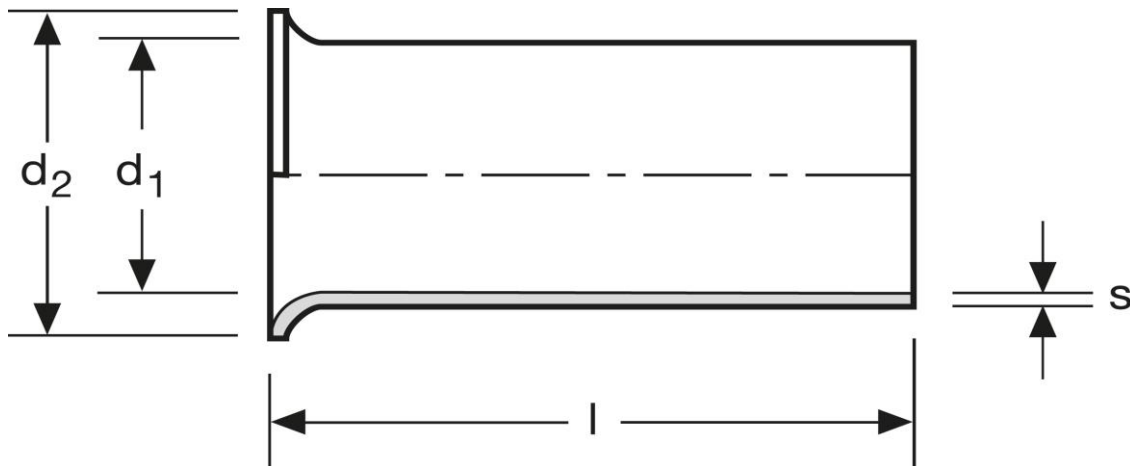

Art.Nr.	Werkstoff	Oberfläche		
A105060BL	Cu-ETP	keine	0,034/1000	1.000
	l	d_1	d_2	s
in mm:	6	1,1	2,1	0,15

Stand: 02.01.2018

Cord end-sleeves 0,5 mm² - 6 mm

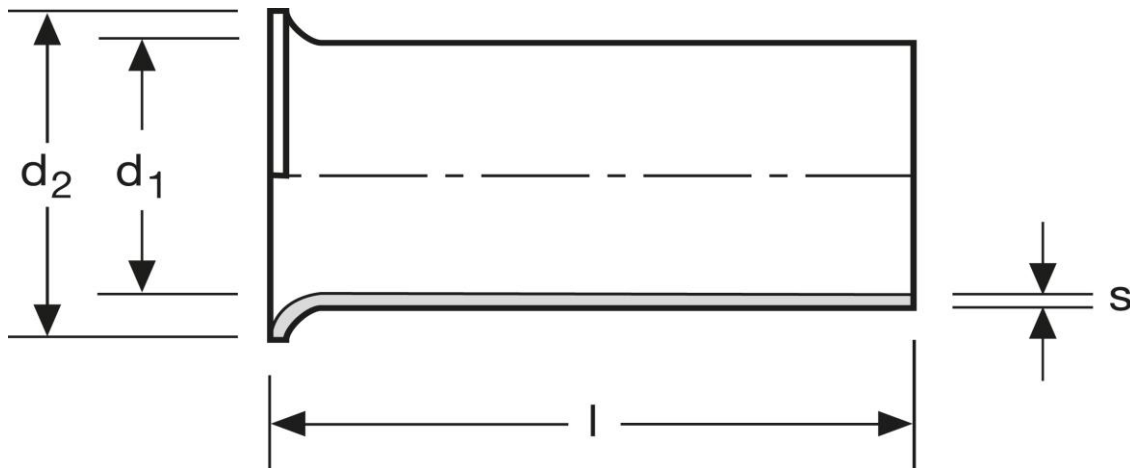

art.no.	material	surface		
A105060BL	Cu-ETP	none	0,034/1000	1.000
	l	d_1	d_2	s
in mm:	6	1,1	2,1	0,15

Date: 02.01.2018