

Al - Pressverbinder
 rm/sm 185 mm² - se 240 mm²

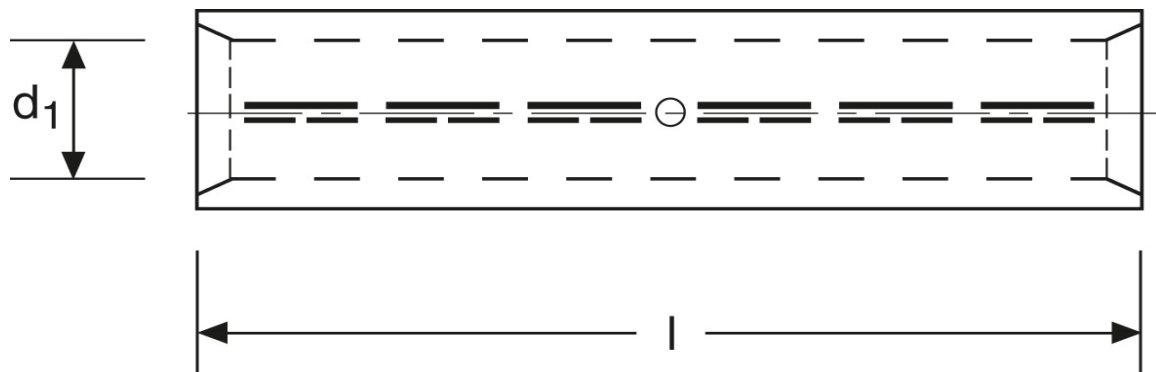

Art.Nr.	Werkstoff		
K3310185	E-Al 99,5	143,0/1000	5

	d ₁	l
in mm:	18,2	125

Stand: 08.08.2014

Al - compression joints
 rm/sm 185 mm² - se 240 mm²

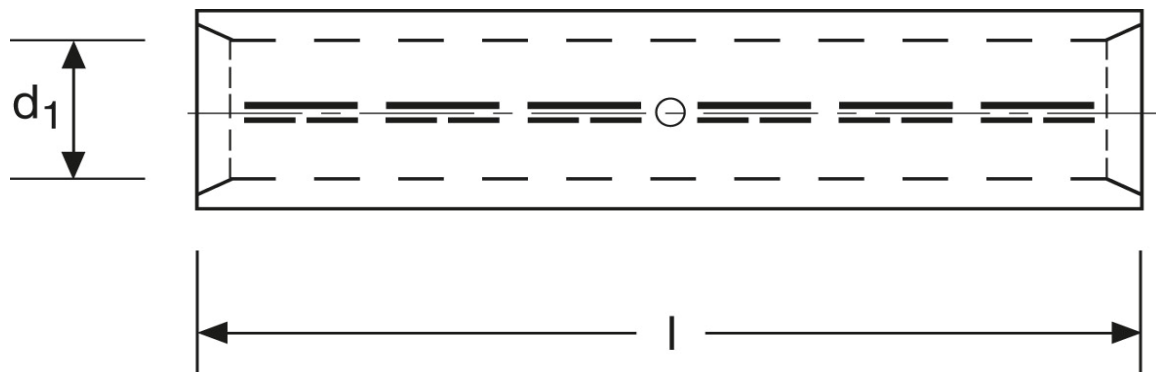

part no.	material		
K3310185	E-Al 99,5	143,0/1000	5

	d ₁	l
in mm:	18,2	125

date: 08.08.2014