

Al - Pressverbinder
 rm/sm 10 mm²

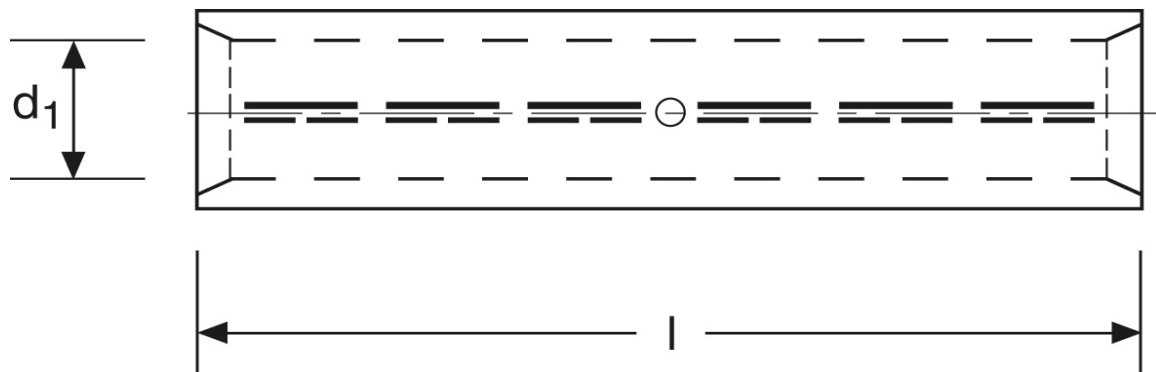

Art.Nr.	Werkstoff		
K3310010	E-Al 99,5	9,5/1000	10

	d ₁	l
in mm:	5,0	55

Stand: 08.08.2014

Al - compression joints
 rm/sm 10 mm²

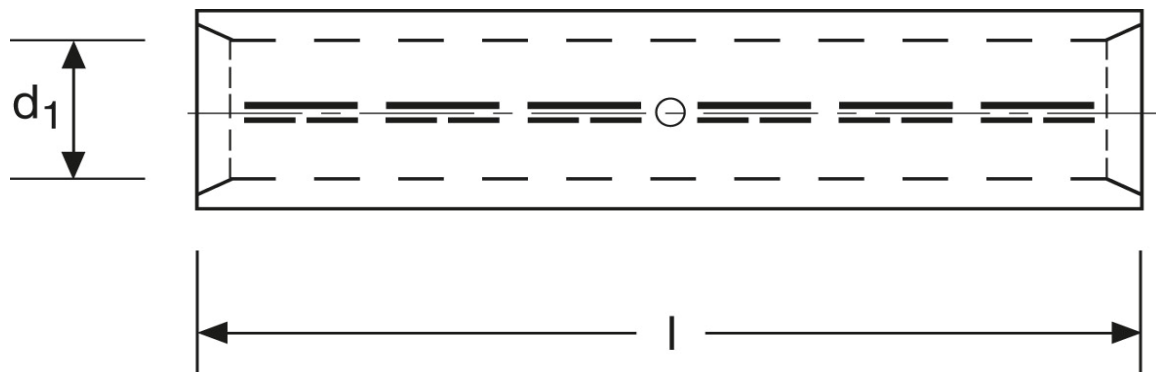

part no.	material		
K3310010	E-Al 99,5	9,5/1000	10

	d ₁	l
in mm:	5,0	55

date: 08.08.2014