

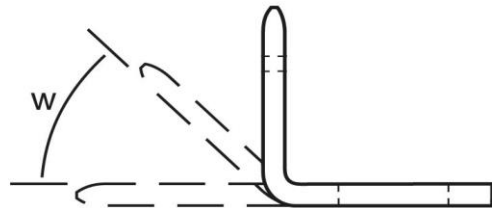

## Geräte-Flachstecker Form B abgewinkelt 90°

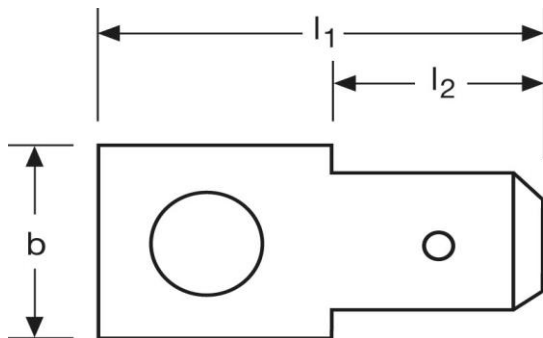

Art.Nr.	Werkstoff	Oberfläche	
F51116830941	Stahl	blank	1.000
	$l_1$	$l_2$	$b$
in mm:	19,0	8,0	8,0
	Steckgröße	M Ø	w
in mm:	6,3 - 0,8	3,2	90°

Stand: 07.10.2014

**Male terminals**  
**form B**  
**angled 90°**

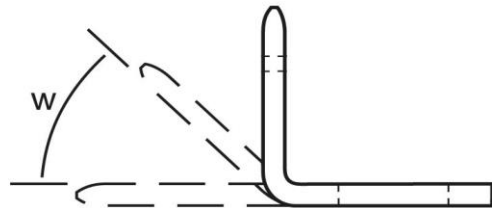
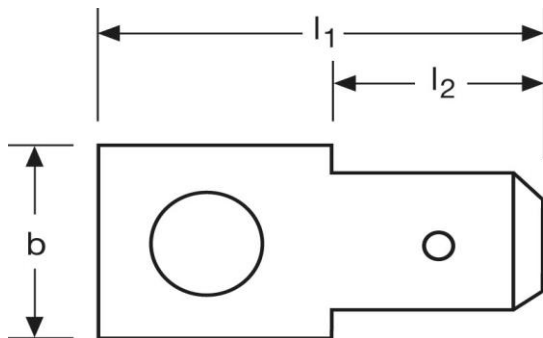

part no.	material	surface	
F51116830941	steel	bare	1.000
	$l_1$	$l_2$	$b$
in mm:	19,0	8,0	8,0
	tab-size	M Ø	w
in mm:	6,3 - 0,8	3,2	90°

date: 07.10.2014