

Geräte-Flachstecker Form B abgewinkelt 90°

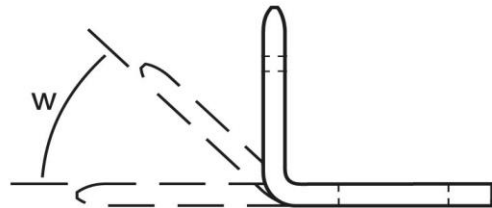

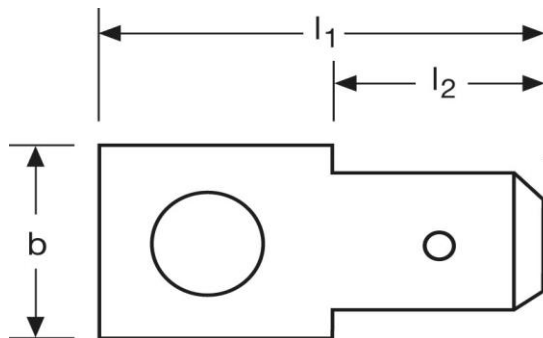

Art.Nr.	Werkstoff	Oberfläche		
F51116830912	Messing	galv. Sn	0,85/1000	1.000
	l_1	l_2	b	
in mm:	19,0	8,0	8,0	
	Steckgröße	M Ø	w	
in mm:	6,3 - 0,8	3,2	90°	

Stand: 24.09.2014

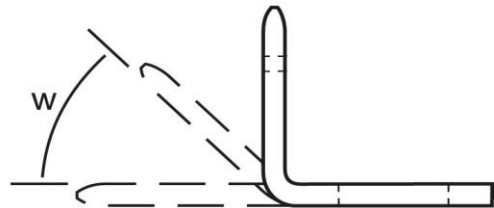
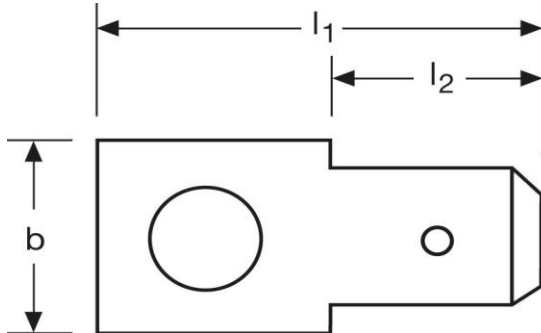
Male terminals
form B
angled 90°

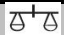

part no.	material	surface		
F51116830912	brass	tin-plated	0,85/1000	1.000
	l_1	l_2	b	
in mm:	19,0	8,0	8,0	
	tab-size	M Ø	w	
in mm:	6,3 - 0,8	3,2	90°	

date: 24.09.2014