

## Geräte-Flachstecker Form B abgewinkelt 90°

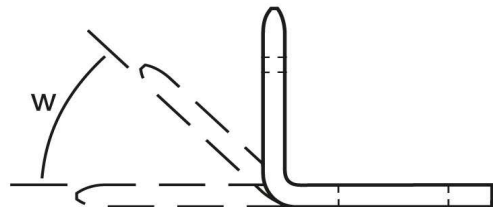
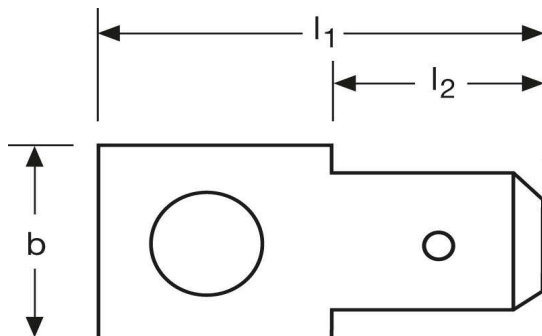

Art.Nr.	Werkstoff	Oberfläche		
F51112830912	Messing	galv. Sn	0,30/1000	1.000
	$l_1$	$l_2$	$b$	
in mm:	13,0	5,5	4,5	
	Steckgröße	M Ø	w	
in mm:	2,8 - 0,8	3,1	90°	

Stand: 24.09.2014

**Male terminals**  
**form B**  
**angled 90°**

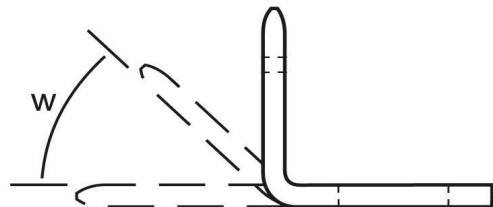
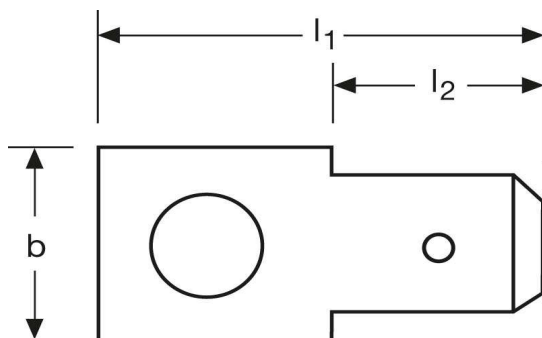

part no.	material	surface		
F51112830912	brass	tin-plated	0,30/1000	1.000
	$l_1$	$l_2$	$b$	
in mm:	13,0	5,5	4,5	
	tab-size	M Ø	w	
in mm:	2,8 - 0,8	3,1	90°	

date: 24.09.2014