

**Geräte-Flachstecker**  
**Form B**  
 abgewinkelt 60°

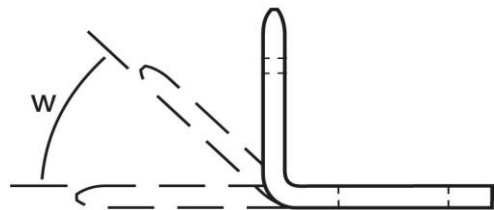
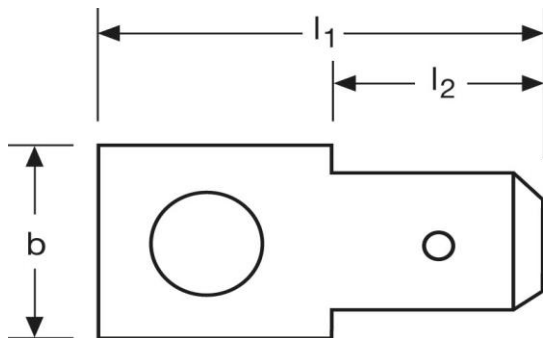

Art.Nr.	Werkstoff	Oberfläche		
F51112830612	Messing	galv. Sn	0,30/1000	1.000
	$l_1$	$l_2$	$b$	
in mm:	13,0	6	4,5	
	Steckgröße	M Ø	w	
in mm:	2,8 - 0,8	3,1	60°	

Stand: 04.03.2019

**Male terminals**  
**form B**  
**angled 60°**

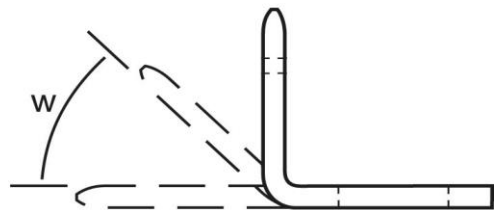
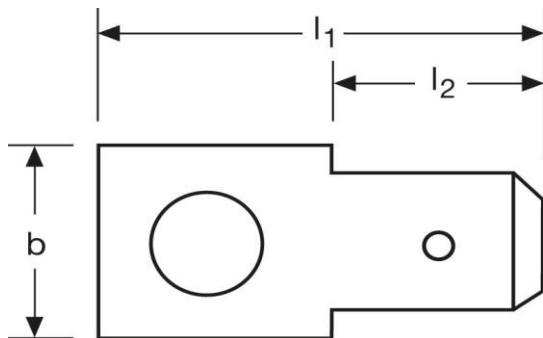

part no.	material	surface		
F51112830612	brass	tin-plated	0,30/1000	1.000
	$l_1$	$l_2$	$b$	
in mm:	13,0	6	4,5	
	tab-size	M Ø	w	
in mm:	2,8 - 0,8	3,1	60°	

date: 04.03.2019