

## Hülsen für verdichtete Leiter "DIN - Ausführung" 300 mm<sup>2</sup>

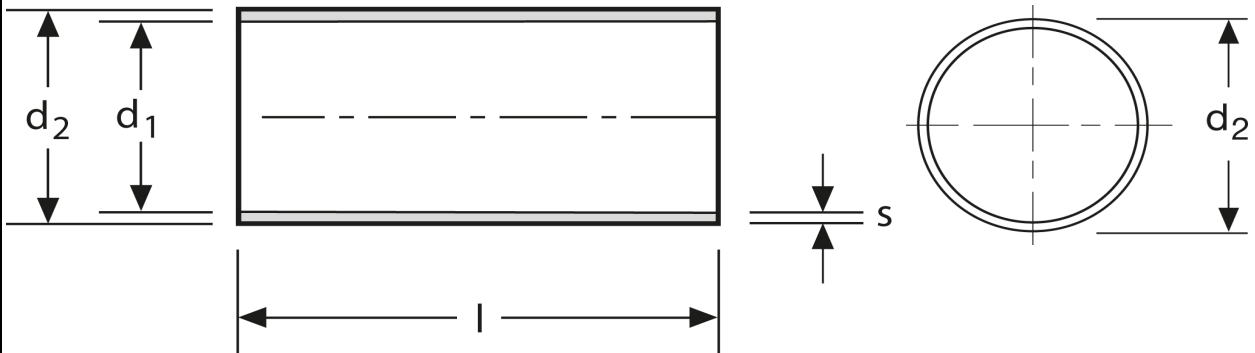



Art.Nr.	Werkstoff	Oberfläche		
A 1813000	Cu-ETP	galv. Sn	9,13/1000	5
	<b>l</b>	<b>d<sub>1</sub></b>	<b>d<sub>2</sub></b>	<b>s</b>
<b>in mm:</b>	<b>48</b>	<b>22,4</b>	<b>23,0</b>	<b>0,30</b>

Stand: 07.07.2014

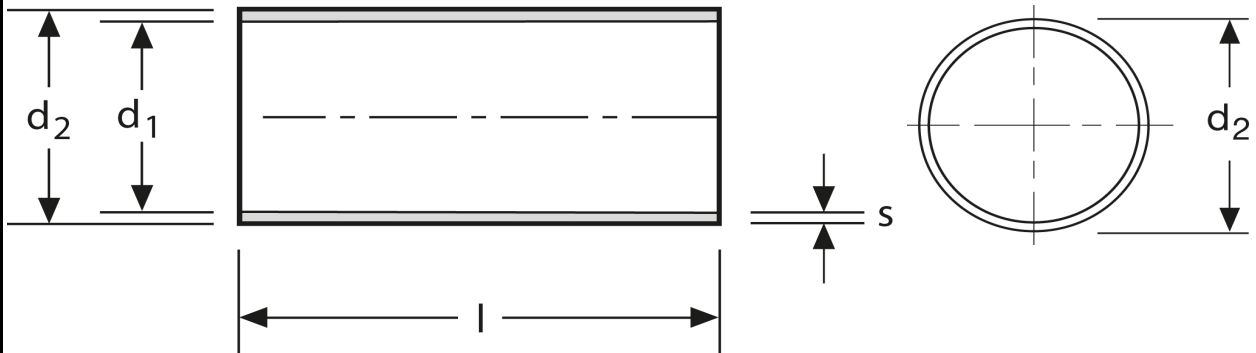
**Sleeves for compacted conductors**  
 "DIN type"  
 300 mm<sup>2</sup>



part no.	material	surface		
A 1813000	Cu-ETP	tin-plated	9,13/1000	5
	<b>l</b>	<b>d<sub>1</sub></b>	<b>d<sub>2</sub></b>	<b>s</b>
<b>in mm:</b>	<b>48</b>	<b>22,4</b>	<b>23,0</b>	<b>0,30</b>

date: 07.07.2014