

Hülsen für verdichtete Leiter "DIN - Ausführung" 240 mm²

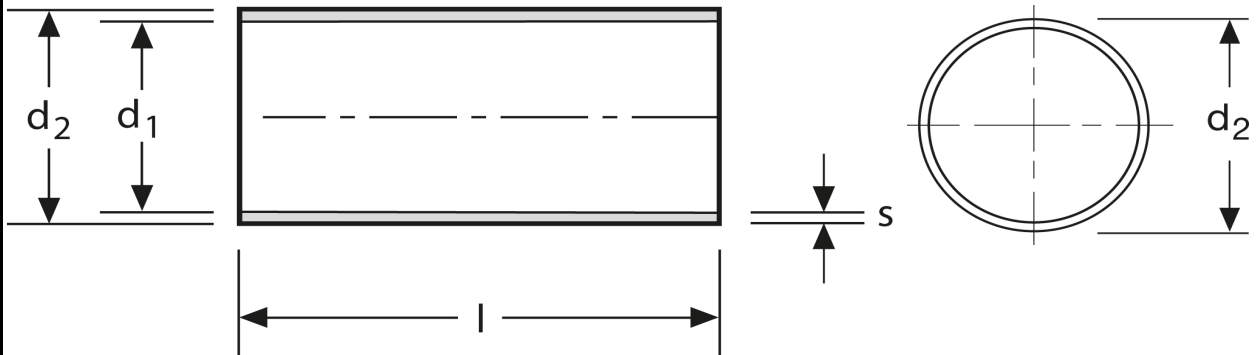



Art.Nr.	Werkstoff	Oberfläche		
A 1812400	Cu-ETP	galv. Sn	6,45/1000	25
	l	d₁	d₂	s
in mm:	38	19,9	20,5	0,30

Stand: 07.07.2014

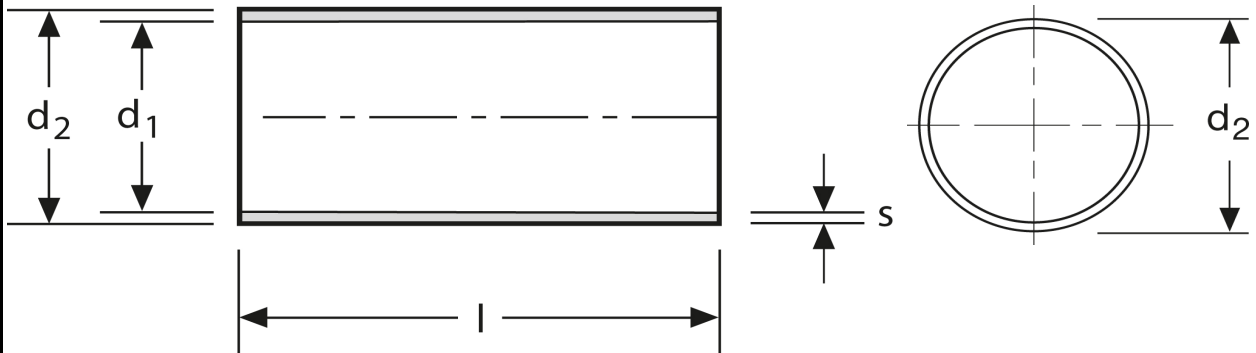
Sleeves for compacted conductors
"DIN type"
240 mm²



part no.	material	surface		
A 1812400	Cu-ETP	tin-plated	6,45/1000	25
	l	d₁	d₂	s
in mm:	38	19,9	20,5	0,30

date: 07.07.2014