

## Hülsen für verdichtete Leiter "DIN - Ausführung" 185 mm<sup>2</sup>

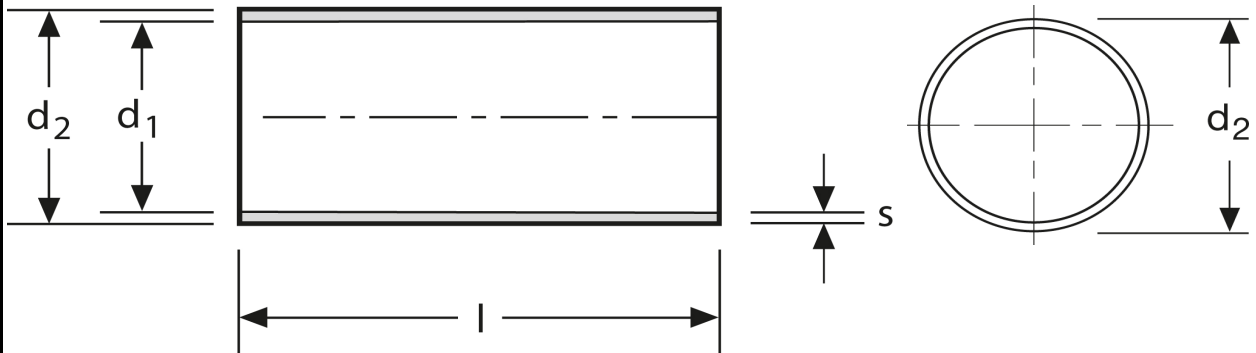



Art.Nr.	Werkstoff	Oberfläche		
A 1811850	Cu-ETP	galv. Sn	5,79/1000	25
	<b>l</b>	<b>d<sub>1</sub></b>	<b>d<sub>2</sub></b>	<b>s</b>
<b>in mm:</b>	<b>38</b>	<b>17,6</b>	<b>18,2</b>	<b>0,30</b>

Stand: 07.07.2014

## Sleeves for compacted conductors

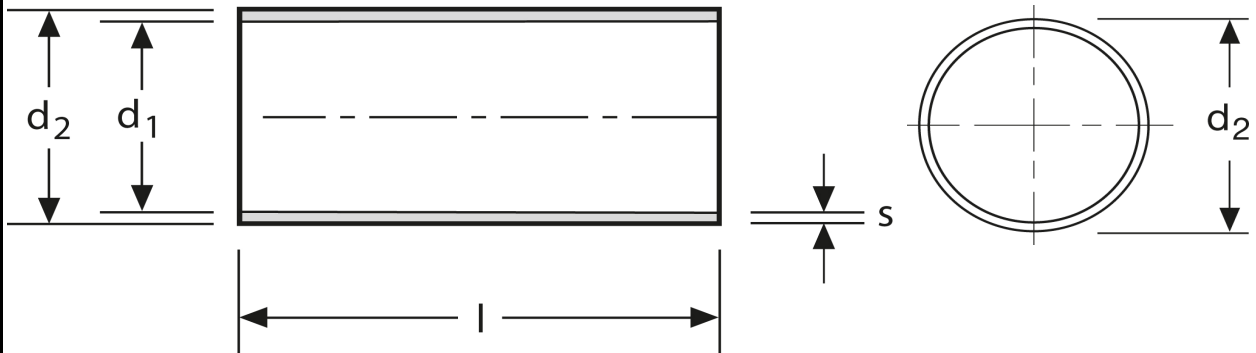
"DIN type"  
185 mm<sup>2</sup>



part no.	material	surface		
A 1811850	Cu-ETP	tin-plated	5,79/1000	25
	<b>l</b>	<b>d<sub>1</sub></b>	<b>d<sub>2</sub></b>	<b>s</b>
<b>in mm:</b>	<b>38</b>	<b>17,6</b>	<b>18,2</b>	<b>0,30</b>

date: 07.07.2014