

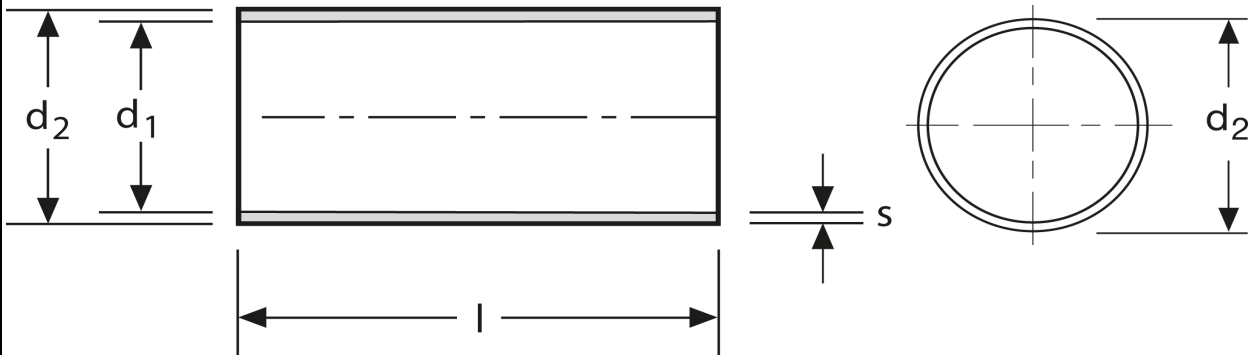

Hülsen für verdichtete Leiter "DIN - Ausführung" 150 mm²

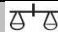

Art.Nr.	Werkstoff	Oberfläche		
A 1811500	Cu-ETP	galv. Sn	3,95/1000	25
	l	d₁	d₂	s
in mm:	30	15,4	16,0	0,30

Stand: 07.07.2014

Sleeves for compacted conductors
 "DIN type"
 150 mm²

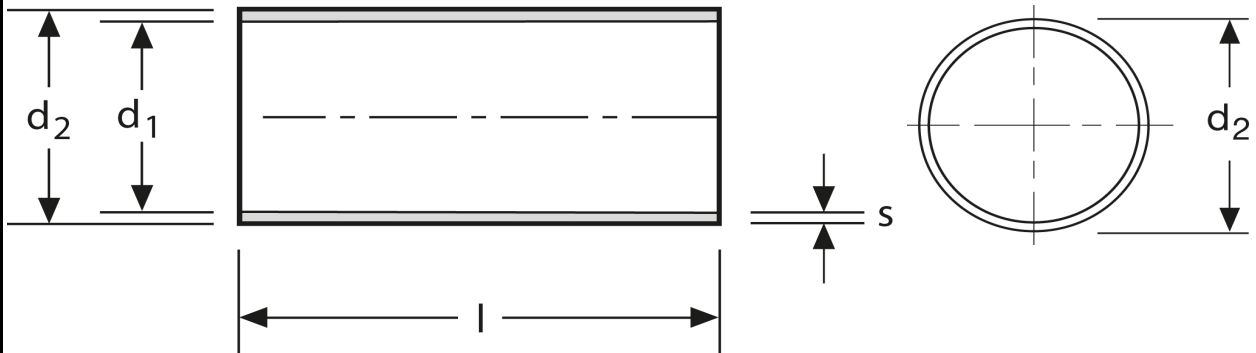

part no.	material	surface		
A 1811500	Cu-ETP	tin-plated	3,95/1000	25
	l	d₁	d₂	s
in mm:	30	15,4	16,0	0,30

date: 07.07.2014