

Hülsen für verdichtete Leiter "DIN - Ausführung" 120 mm²

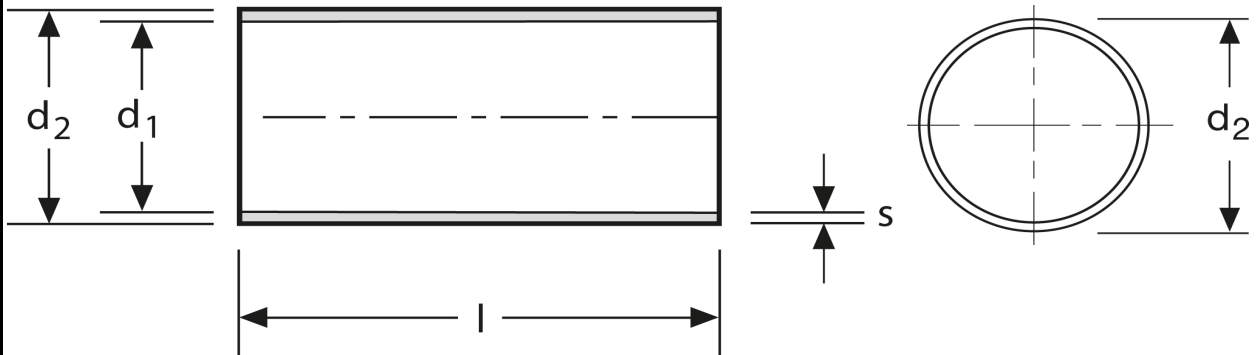



Art.Nr.	Werkstoff	Oberfläche		
A 1811200	Cu-ETP	galv. Sn	3,57/1000	50
	l	d₁	d₂	s
in mm:	30	13,9	14,5	0,30

Stand: 07.07.2014

Sleeves for compacted conductors

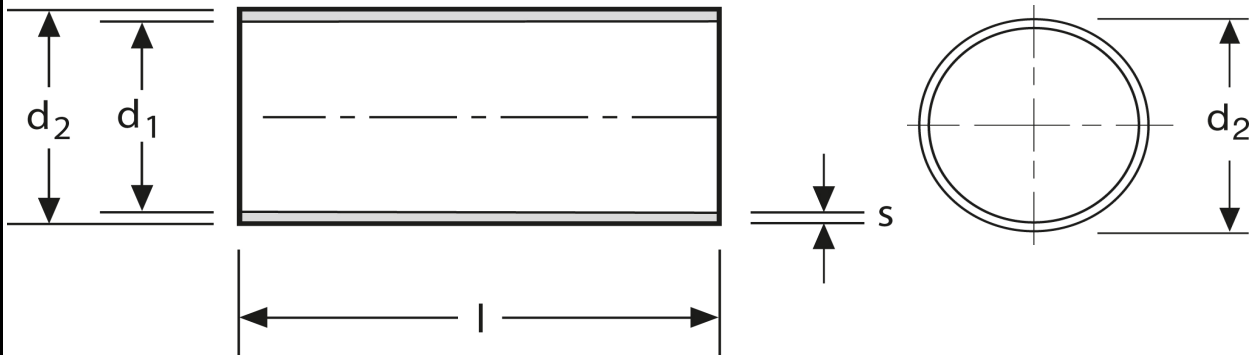
"DIN type"
120 mm²



part no.	material	surface		
A 1811200	Cu-ETP	tin-plated	3,57/1000	50
	l	d₁	d₂	s
in mm:	30	13,9	14,5	0,30

date: 07.07.2014