

## Hülsen für verdichtete Leiter "DIN - Ausführung" 95 mm<sup>2</sup>

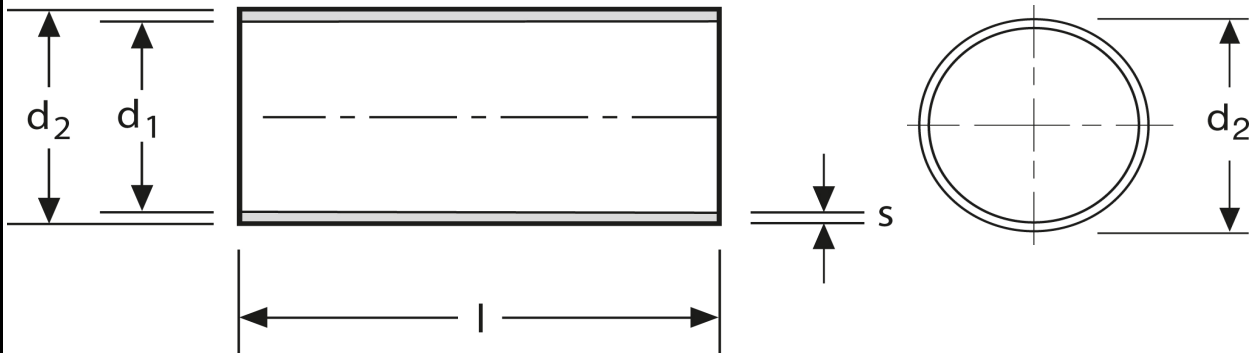

Art.Nr.	Werkstoff	Oberfläche		
A 1810950	Cu-ETP	galv. Sn	2,98/1000	50
	<b>l</b>	<b>d<sub>1</sub></b>	<b>d<sub>2</sub></b>	<b>s</b>
<b>in mm:</b>	<b>28</b>	<b>12,4</b>	<b>13,0</b>	<b>0,30</b>

Stand: 07.07.2014

**Sleeves for compacted conductors**  
 "DIN type"  
 95 mm<sup>2</sup>

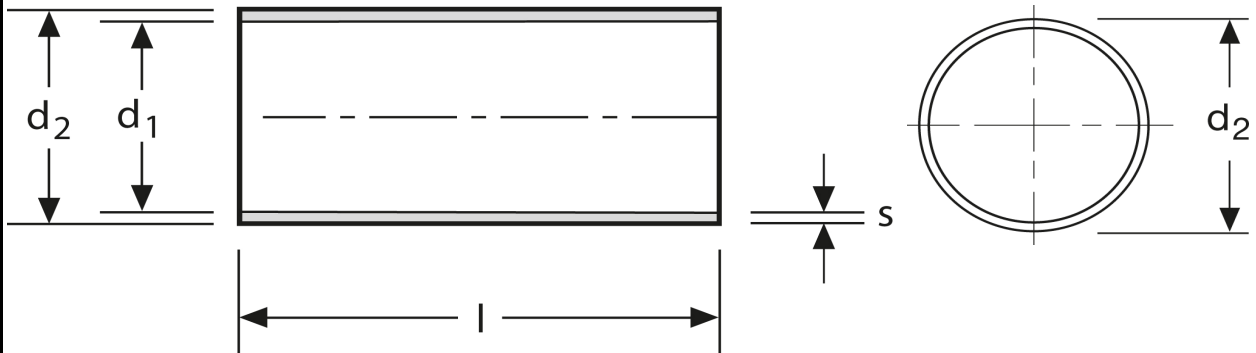

part no.	material	surface		
A 1810950	Cu-ETP	tin-plated	2,98/1000	50
	<b>l</b>	<b>d<sub>1</sub></b>	<b>d<sub>2</sub></b>	<b>s</b>
<b>in mm:</b>	<b>28</b>	<b>12,4</b>	<b>13,0</b>	<b>0,30</b>

date: 07.07.2014