

Hülsen für verdichtete Leiter "DIN - Ausführung" 70 mm²

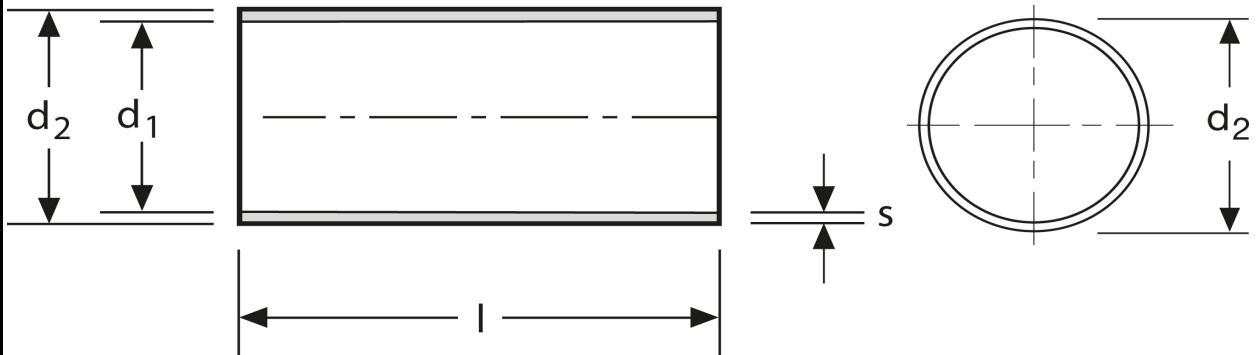



Art.Nr.	Werkstoff	Oberfläche		
A 1810700	Cu-ETP	galv. Sn	2,19/1000	50
	l	d₁	d₂	s
in mm:	24	10,6	11,2	0,30

Stand: 07.07.2014

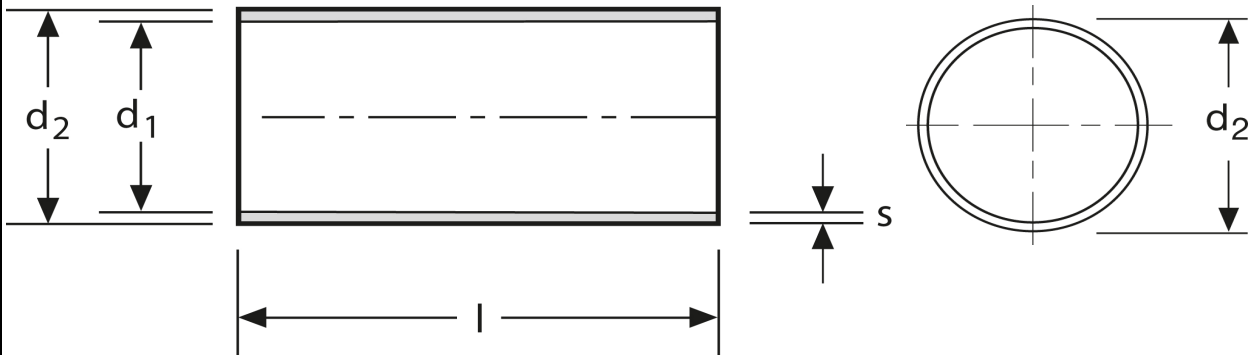
Sleeves for compacted conductors
 "DIN type"
 70 mm²



part no.	material	surface		
A 1810700	Cu-ETP	tin-plated	2,19/1000	50
	l	d₁	d₂	s
in mm:	24	10,6	11,2	0,30

date: 07.07.2014