

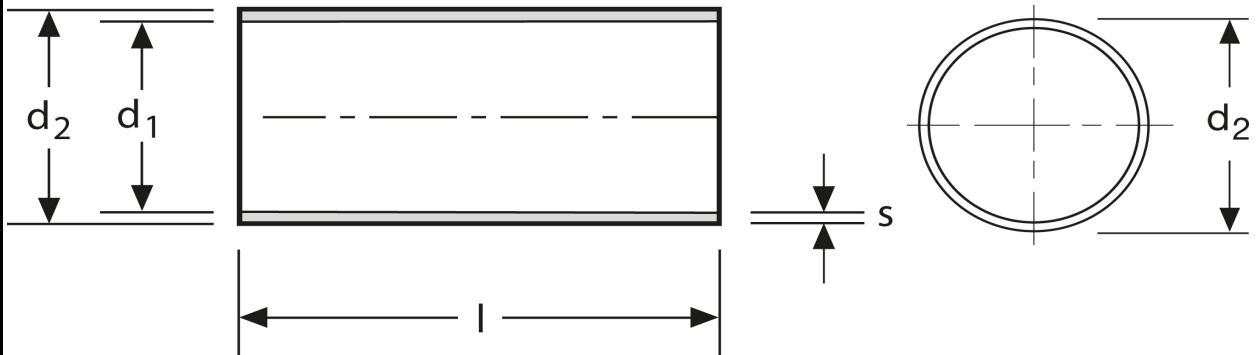

Hülsen für verdichtete Leiter "DIN - Ausführung" 50 mm²



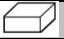

Art.Nr.	Werkstoff	Oberfläche		
A 1810500	Cu-ETP	galv. Sn	1,51/1000	50
	l	d₁	d₂	s
in mm:	23	9,0	9,5	0,25

Stand: 07.07.2014

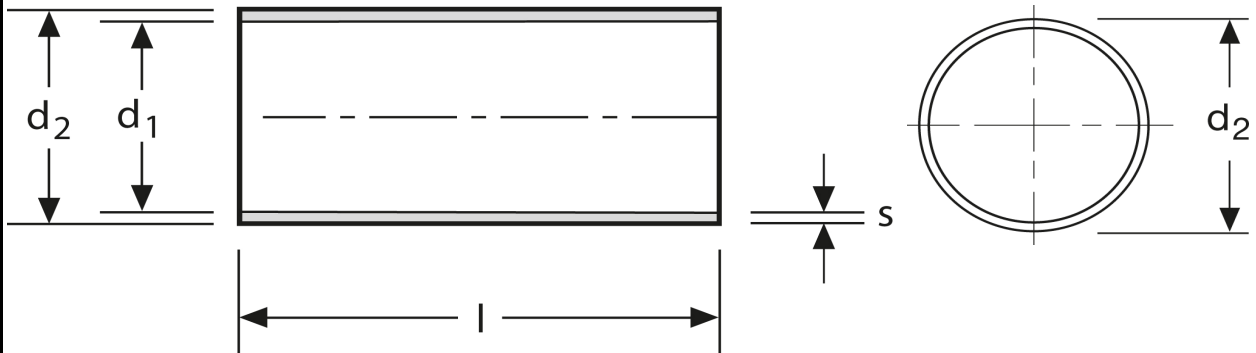
Sleeves for compacted conductors
 "DIN type"
 50 mm²



part no.	material	surface		
A 1810500	Cu-ETP	tin-plated	1,51/1000	50
	l	d₁	d₂	s
in mm:	23	9,0	9,5	0,25

date: 07.07.2014