

## Hülsen für verdichtete Leiter "DIN - Ausführung" 35 mm<sup>2</sup>

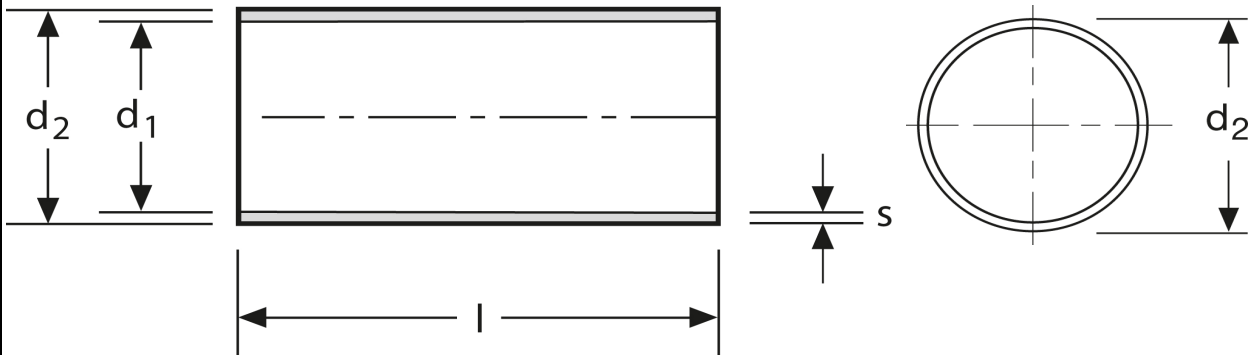



Art.Nr.	Werkstoff	Oberfläche		
A 1810350	Cu-ETP	galv. Sn	0,94/1000	100
	<b>l</b>	<b>d<sub>1</sub></b>	<b>d<sub>2</sub></b>	<b>s</b>
<b>in mm:</b>	17	7,7	8,2	0,25

Stand: 07.07.2014

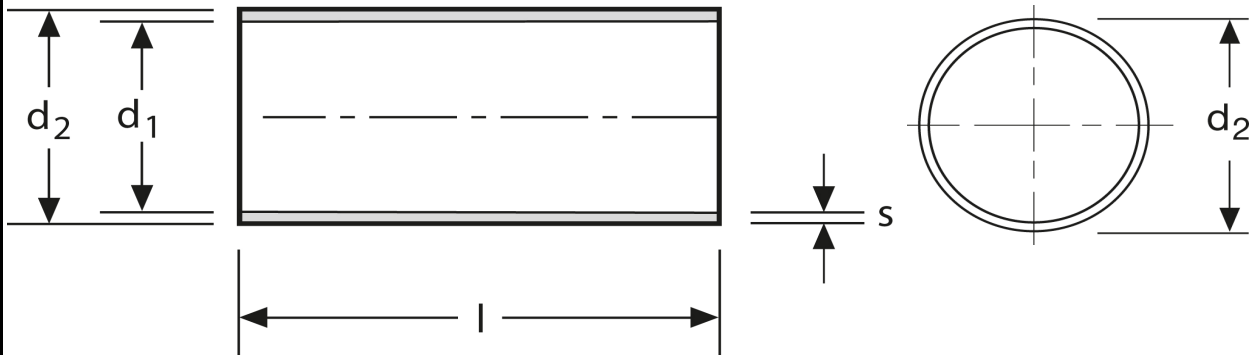
**Sleeves for compacted conductors**  
"DIN type"  
35 mm<sup>2</sup>



part no.	material	surface		
A 1810350	Cu-ETP	tin-plated	0,94/1000	100
	<b>l</b>	<b>d<sub>1</sub></b>	<b>d<sub>2</sub></b>	<b>s</b>
<b>in mm:</b>	17	7,7	8,2	0,25

date: 07.07.2014