

Hülsen für verdichtete Leiter "DIN - Ausführung" 16 mm²

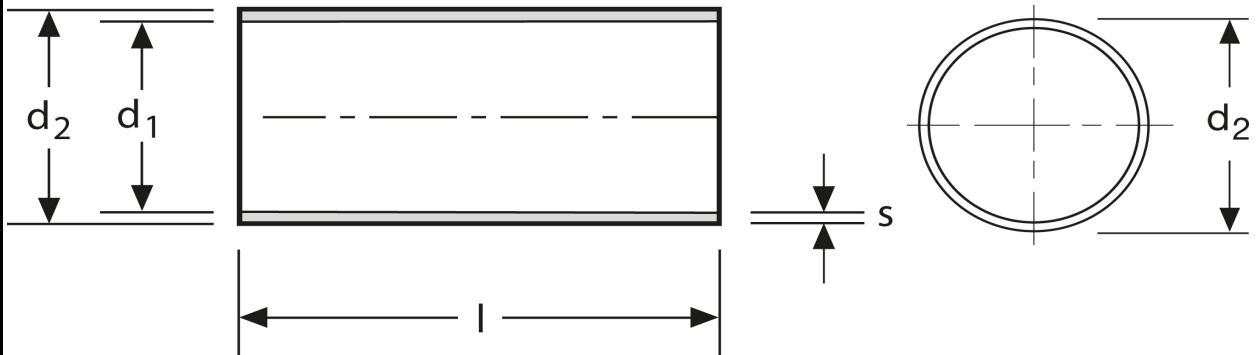

Art.Nr.	Werkstoff	Oberfläche		
A 1810160	Cu-ETP	galv. Sn	0,35/1000	100
	l	d₁	d₂	s
in mm:	16	5,0	5,3	0,15

Stand: 07.07.2014

Sleeves for compacted conductors
"DIN type"
16 mm²

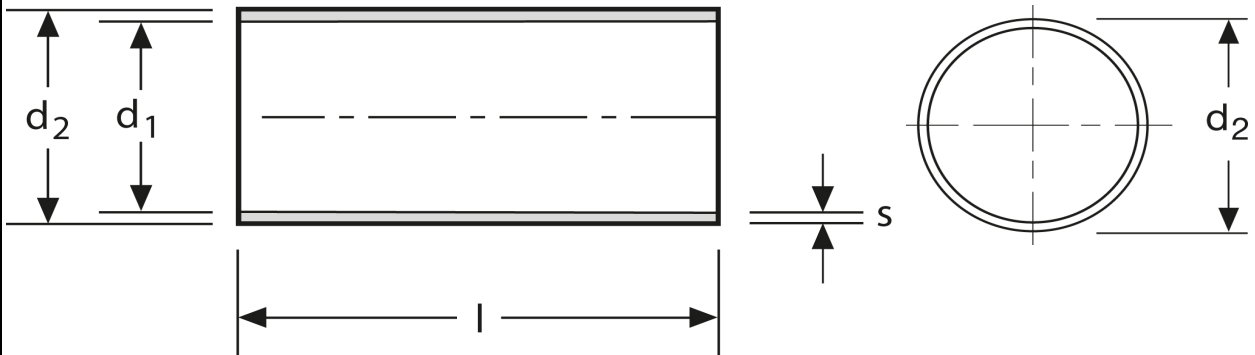

part no.	material	surface		
A 1810160	Cu-ETP	tin-plated	0,35/1000	100
	l	d₁	d₂	s
in mm:	16	5,0	5,3	0,15

date: 07.07.2014