

Hülsen für verdichtete Leiter Normalausführung 400 mm²

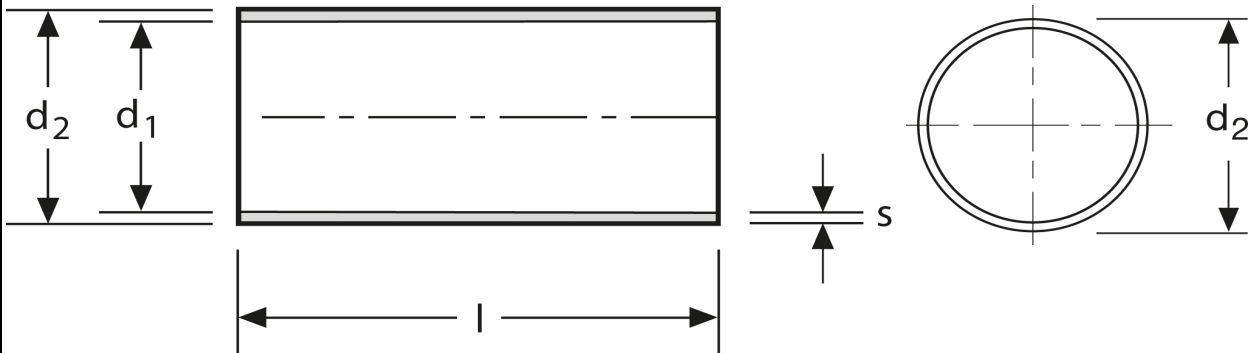

Art.Nr.	Werkstoff	Oberfläche		
A 1804000	Cu-ETP	galv. Sn	11,08/1000	10
	l	d₁	d₂	s
in mm:	38	25,4	26,2	0,40

Stand: 07.07.2014

Sleeves for compacted conductors
standard type
400 mm²

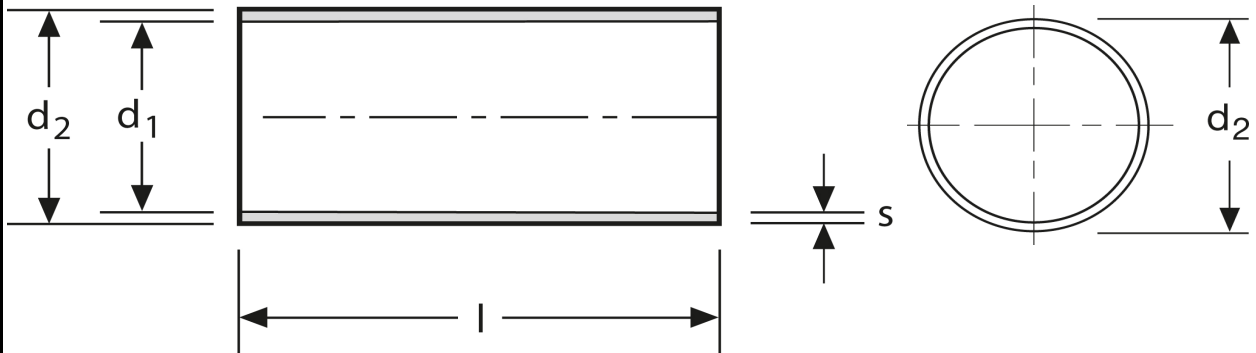

part no.	material	surface		
A 1804000	Cu-ETP	tin-plated	11,08/1000	10
	l	d₁	d₂	s
in mm:	38	25,4	26,2	0,40

date: 07.07.2014