

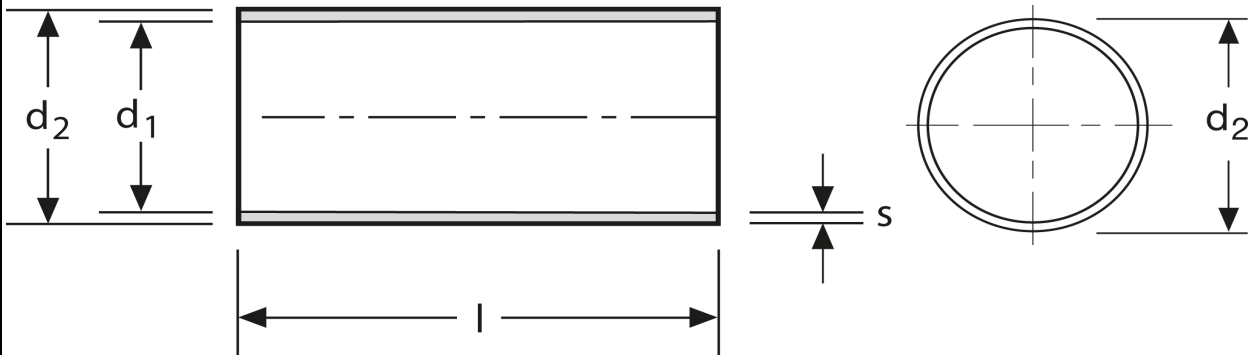

Hülsen für verdichtete Leiter Normalausführung 300 mm²



Art.Nr.	Werkstoff	Oberfläche		
A 1803000	Cu-ETP	galv. Sn	7,23/1000	10
	l	d₁	d₂	s
in mm:	38	22,4	23,0	0,30

Stand: 07.07.2014

Sleeves for compacted conductors
 standard type
 300 mm²

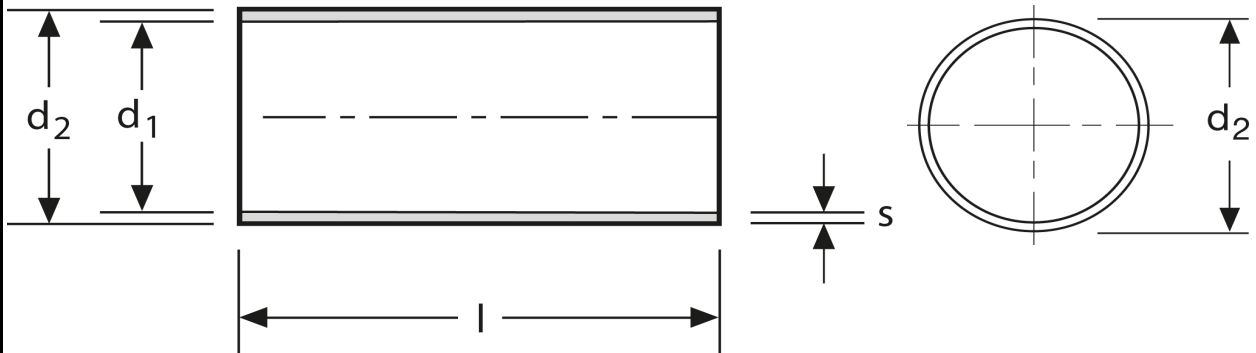

part no.	material	surface		
A 1803000	Cu-ETP	tin-plated	7,23/1000	10
	l	d₁	d₂	s
in mm:	38	22,4	23,0	0,30

date: 07.07.2014