

## Hülsen für verdichtete Leiter Normalausführung 240 mm<sup>2</sup>

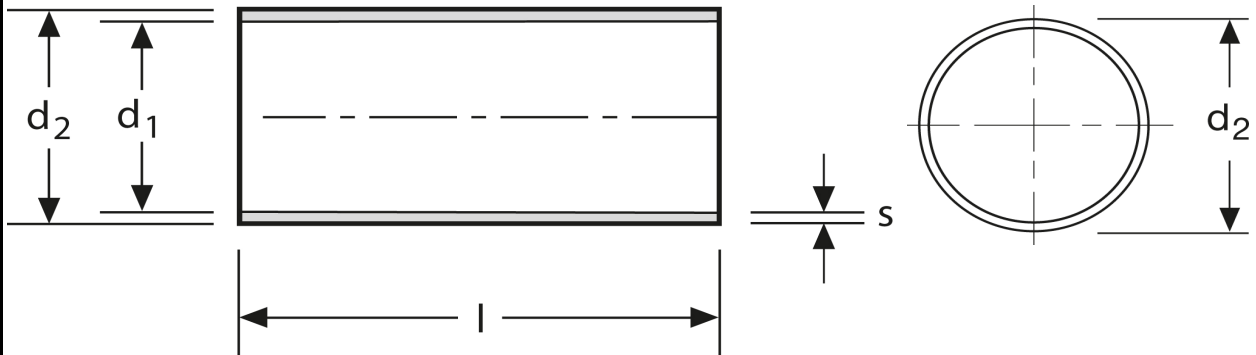



Art.Nr.	Werkstoff	Oberfläche		
A 1802400	Cu-ETP	galv. Sn	5,08/1000	25
	<b>l</b>	<b>d<sub>1</sub></b>	<b>d<sub>2</sub></b>	<b>s</b>
<b>in mm:</b>	<b>30</b>	<b>19,9</b>	<b>20,5</b>	<b>0,30</b>

Stand: 07.07.2014

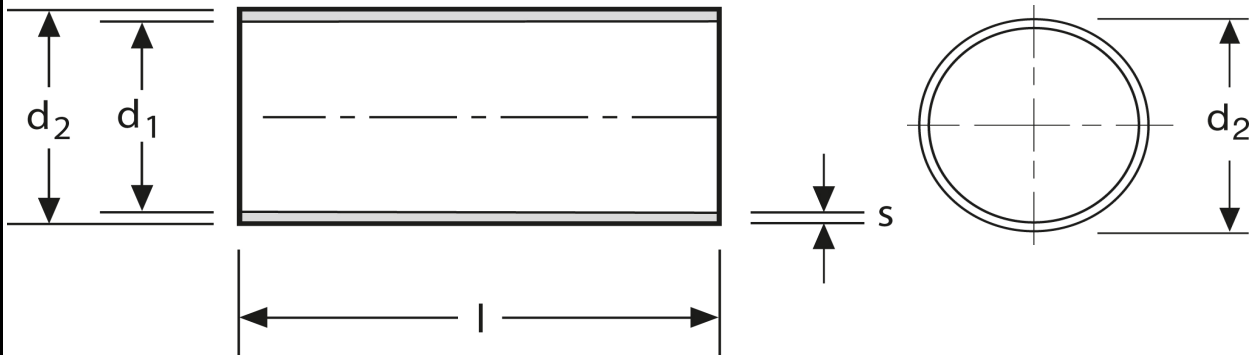
**Sleeves for compacted conductors**  
 standard type  
 240 mm<sup>2</sup>



part no.	material	surface		
A 1802400	Cu-ETP	tin-plated	5,08/1000	25
	<b>l</b>	<b>d<sub>1</sub></b>	<b>d<sub>2</sub></b>	<b>s</b>
<b>in mm:</b>	30	19,9	20,5	0,30

date: 07.07.2014