

Hülsen für verdichtete Leiter Normalausführung 150 mm²

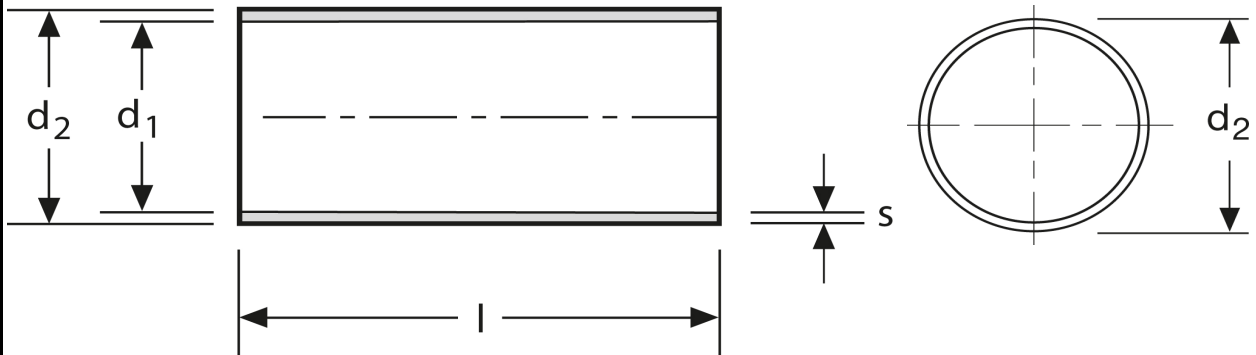



Art.Nr.	Werkstoff	Oberfläche		
A 1801500	Cu-ETP	galv. Sn	3,42/1000	25
	l	d₁	d₂	s
in mm:	26	15,4	16,0	0,30

Stand: 07.07.2014

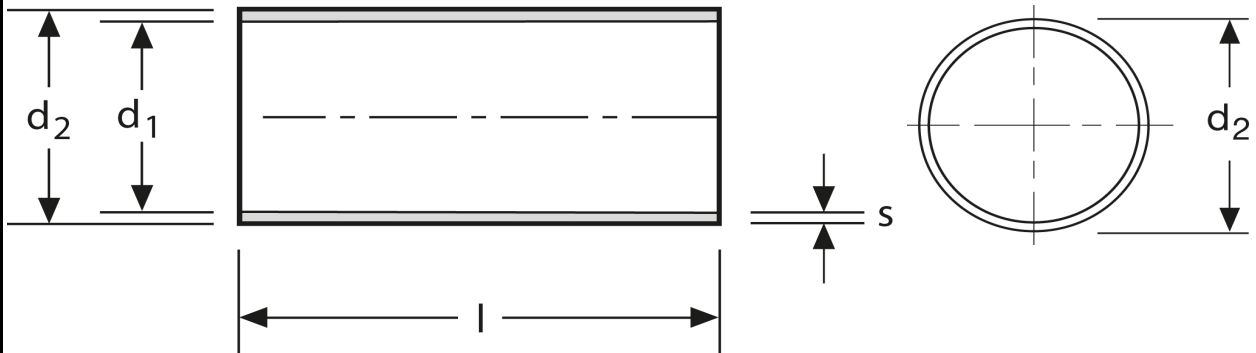
Sleeves for compacted conductors
 standard type
 150 mm²



part no.	material	surface		
A 1801500	Cu-ETP	tin-plated	3,42/1000	25
	l	d₁	d₂	s
in mm:	26	15,4	16,0	0,30

date: 07.07.2014