

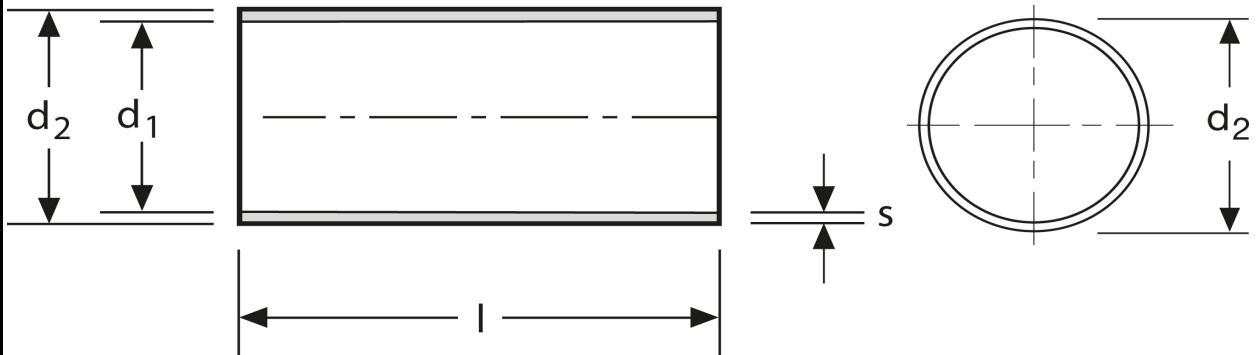

## Hülsen für verdichtete Leiter Normalausführung 95 mm<sup>2</sup>



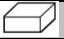

Art.Nr.	Werkstoff	Oberfläche		
A 1800950	Cu-ETP	galv. Sn	2,23/1000	50
	<b>l</b>	<b>d<sub>1</sub></b>	<b>d<sub>2</sub></b>	<b>s</b>
<b>in mm:</b>	21	12,4	13,0	0,30

Stand: 07.07.2014

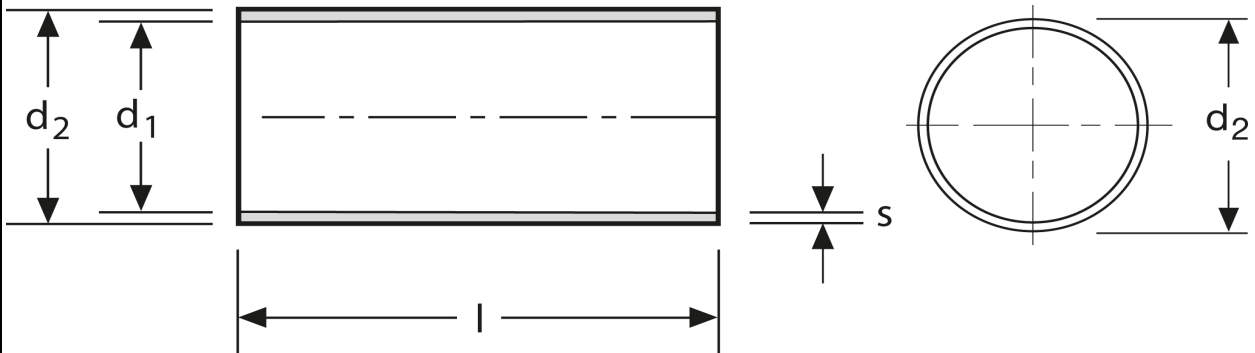
**Sleeves for compacted conductors**  
 standard type  
 95 mm<sup>2</sup>



part no.	material	surface		
A 1800950	Cu-ETP	tin-plated	2,23/1000	50
	<b>l</b>	<b>d<sub>1</sub></b>	<b>d<sub>2</sub></b>	<b>s</b>
<b>in mm:</b>	21	12,4	13,0	0,30

date: 07.07.2014