

Hülsen für verdichtete Leiter Normalausführung 70 mm²

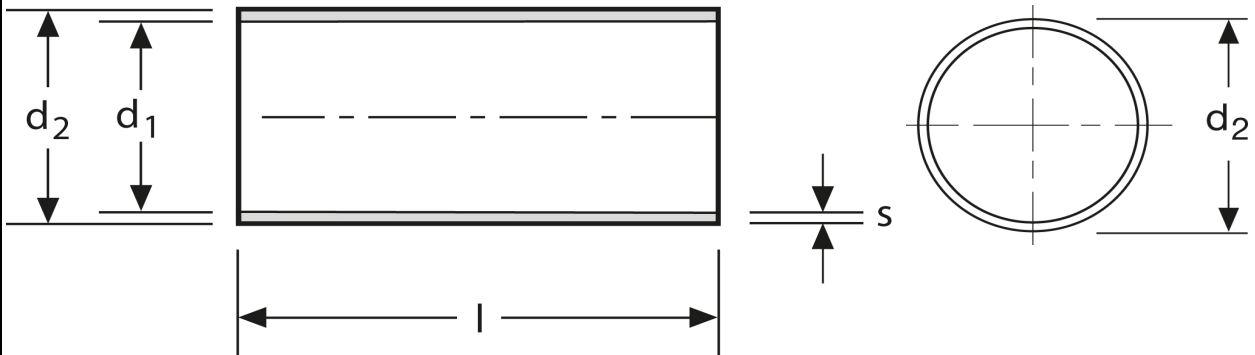

Art.Nr.	Werkstoff	Oberfläche		
A 1800700	Cu-ETP	galv. Sn	1,73/1000	50
	l	d₁	d₂	s
in mm:	19	10,6	11,2	0,30

Stand: 07.07.2014

Sleeves for compacted conductors
 standard type
 70 mm²

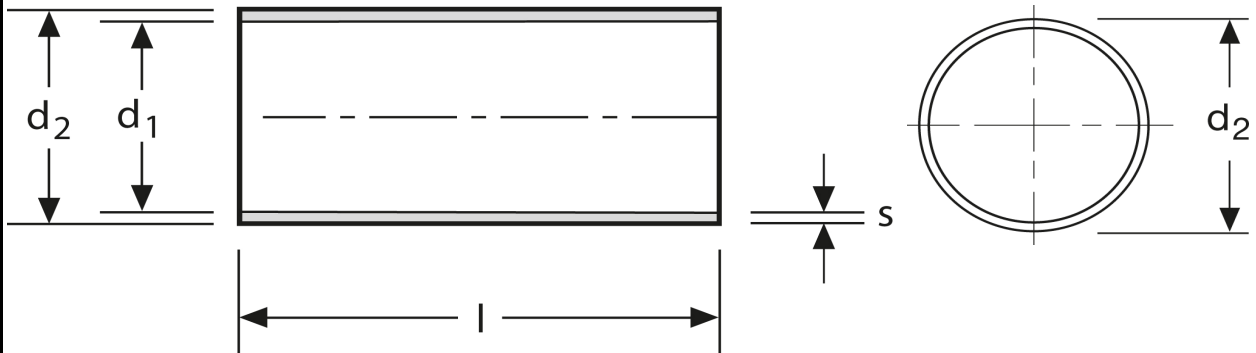

part no.	material	surface		
A 1800700	Cu-ETP	tin-plated	1,73/1000	50
	l	d₁	d₂	s
in mm:	19	10,6	11,2	0,30

date: 07.07.2014