

## Aderendhülsen 16 mm<sup>2</sup> - 20 mm

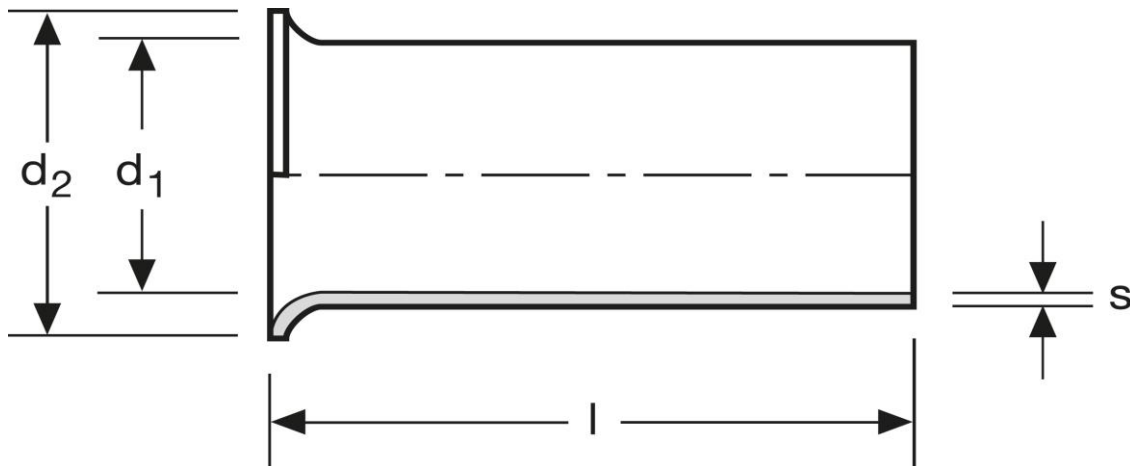

Art.Nr.	Werkstoff	Oberfläche		
A113200BL	Cu-ETP	keine	0,703/1000	100
	l	d <sub>1</sub>	d <sub>2</sub>	s
in mm:	20	5,9	7,5	0,20

Stand: 02.01.2018

## Cord end-sleeves 16 mm<sup>2</sup> - 20 mm

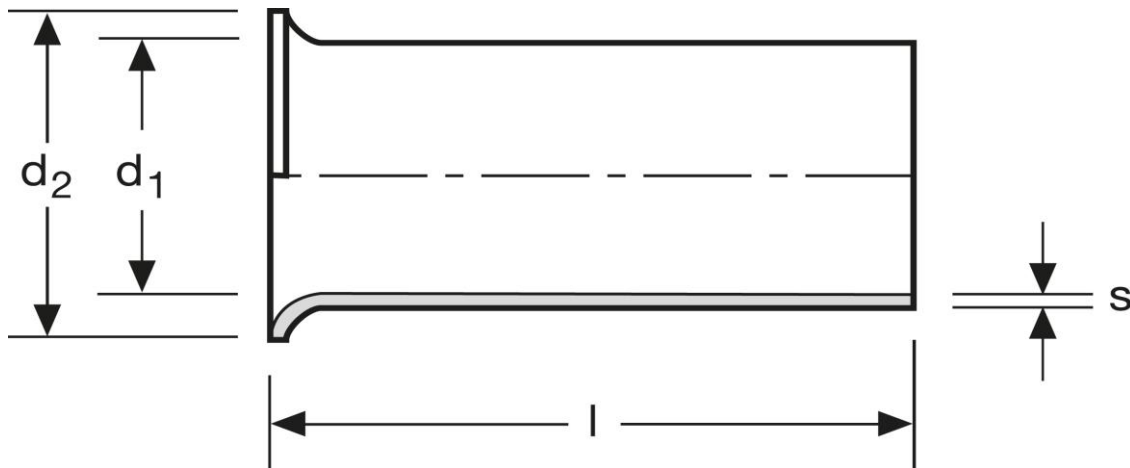

art.no.	material	surface		
A113200BL	Cu-ETP	none	0,703/1000	100
in mm:	l	d <sub>1</sub>	d <sub>2</sub>	s
	20	5,9	7,5	0,20

Date: 02.01.2018