

Aderendhülsen 10 mm² - 15 mm

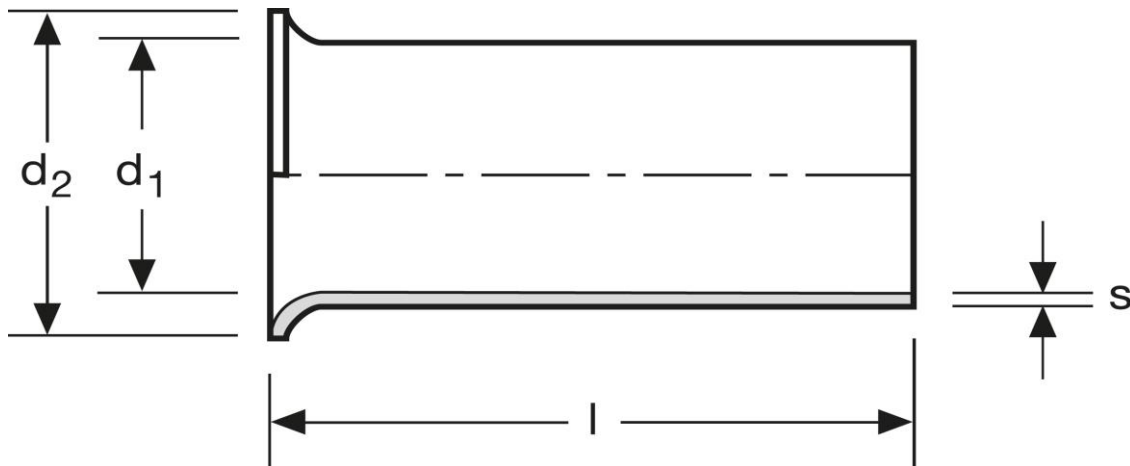

Art.Nr.	Werkstoff	Oberfläche		
A112150BL	Cu-ETP	keine	0,429/1000	500
	l	d_1	d_2	s
in mm:	15	4,6	5,8	0,20

Stand: 02.01.2018

Cord end-sleeves
 10 mm² - 15 mm

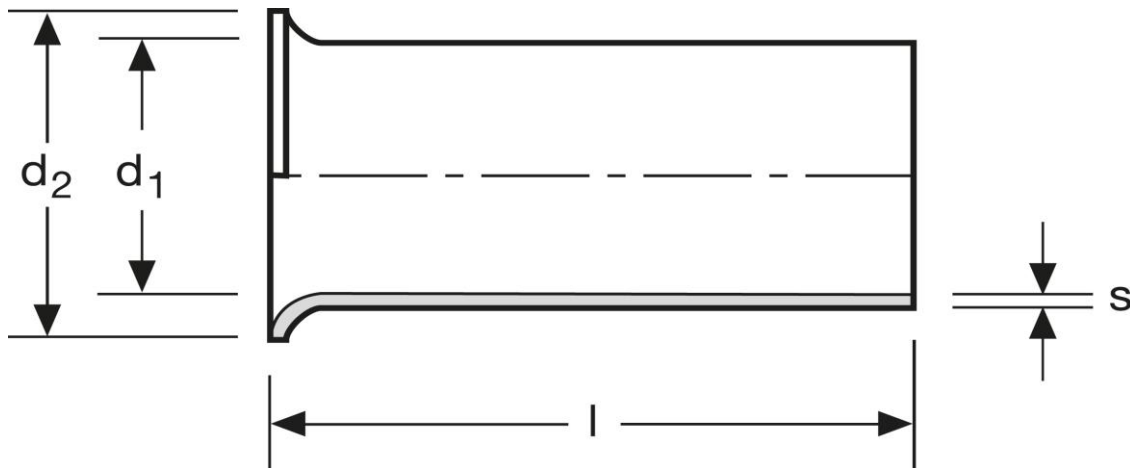

art.no.	material	surface		
A112150BL	Cu-ETP	none	0,429/1000	500
in mm:	l	d ₁	d ₂	s
	15	4,6	5,8	0,20

Date: 02.01.2018