

## Aderendhülsen 6 mm<sup>2</sup> - 15 mm

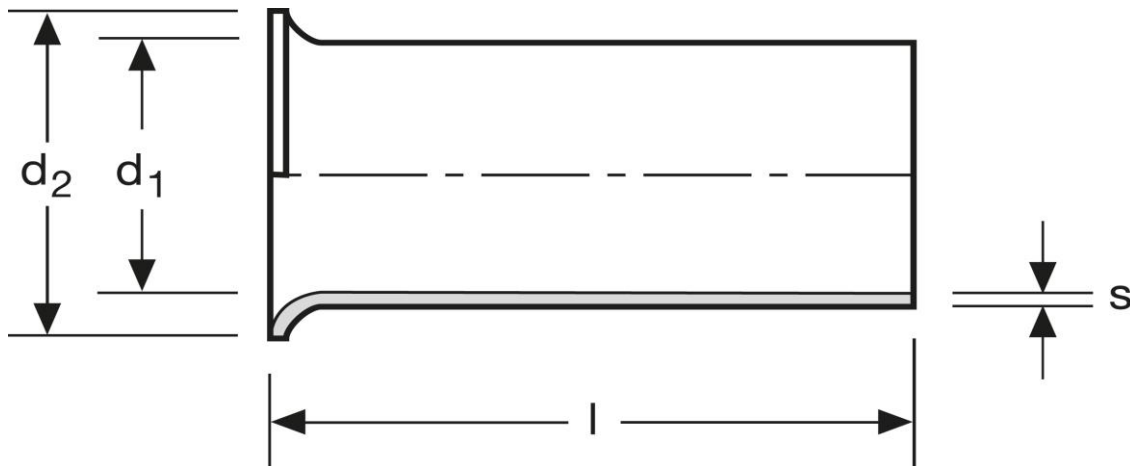

Art.Nr.	Werkstoff	Oberfläche		
A111150BL	Cu-ETP	keine	0,347/1000	500
	l	d <sub>1</sub>	d <sub>2</sub>	s
in mm:	15	3,6	4,7	0,20

Stand: 02.01.2018

## Cord end-sleeves 6 mm<sup>2</sup> - 15 mm

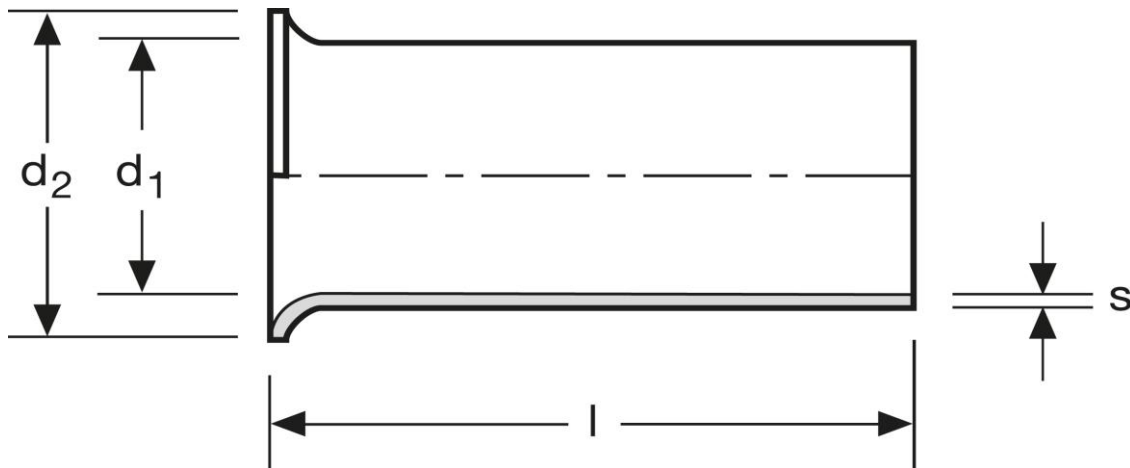

art.no.	material	surface		
A111150BL	Cu-ETP	none	0,347/1000	500
	$l$	$d_1$	$d_2$	$s$
in mm:	15	3,6	4,7	0,20

Date: 02.01.2018