

Aderendhülsen 0,75 mm² - 10 mm

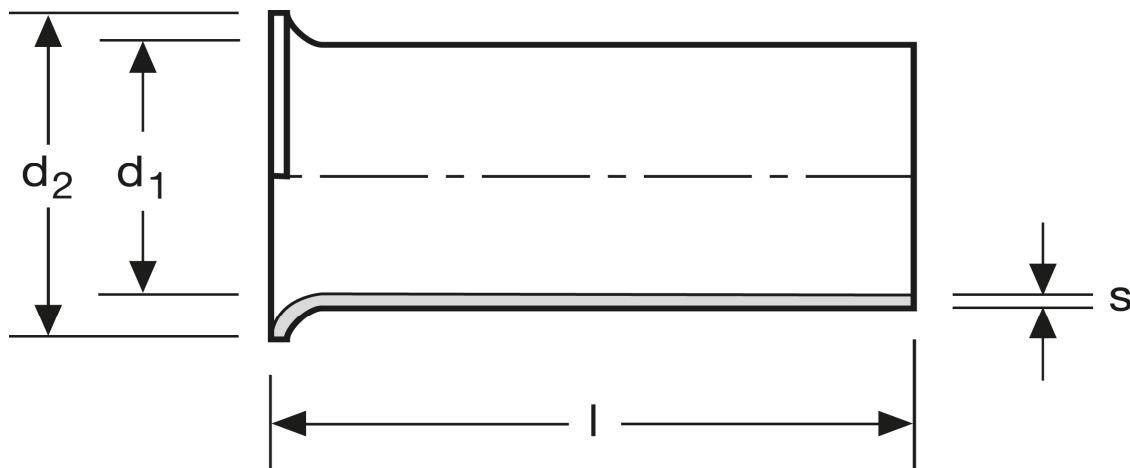

Art.Nr.	Werkstoff	Oberfläche		
A 106101	Cu-ETP	galv. Ag	0,064/1000	1.000
	l	d ₁	d ₂	s
in mm:	10	1,3	2,3	0,15

Stand: 01.07.2014

Cord end-sleeves

0,75 mm² - 10 mm

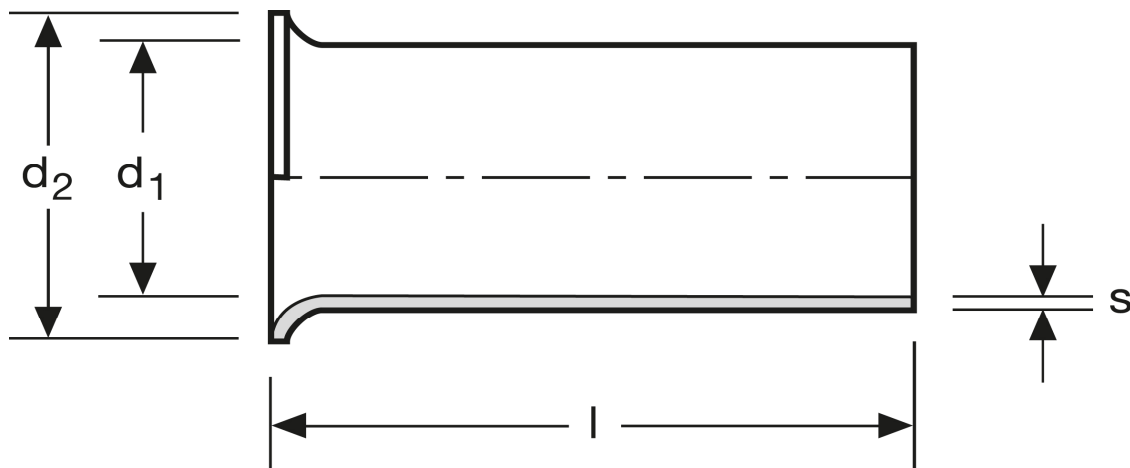

art.no.	material	surface		
A 106101	Cu-ETP	silv. plated	0,064/1000	1.000
	l	d₁	d₂	s
in mm:	10	1,3	2,3	0,15

Date: 01.07.2014