

Aderendhülsen

0,34 mm² - 10 mm

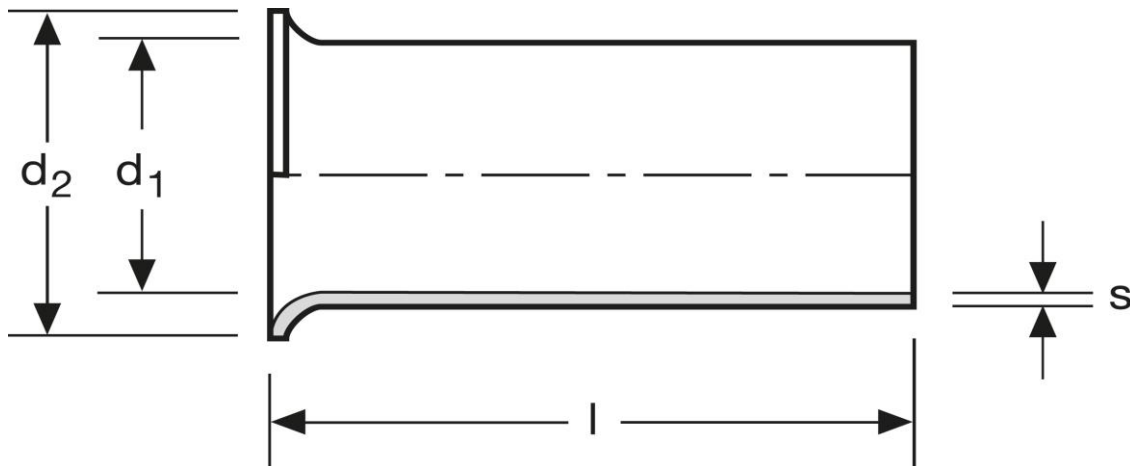

Art.Nr.	Werkstoff	Oberfläche		
A 104101	Cu-ETP	galv. Ag	0,040/1000	1.000
	l	d₁	d₂	s
in mm:	10	0,9	1,8	0,15

Stand: 03.01.2019

Cord end-sleeves
 0,34 mm² - 10 mm

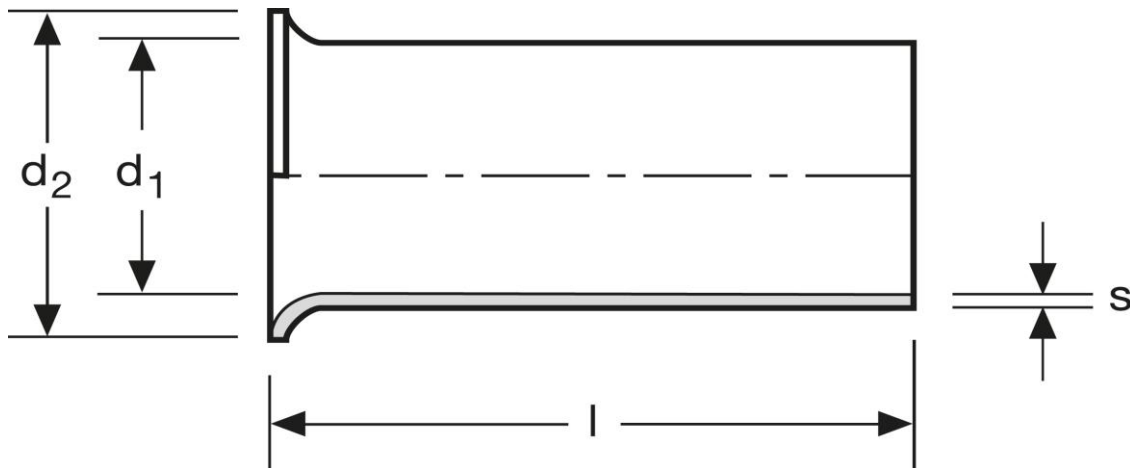

art.no.	material	surface		
A 104101	Cu-ETP	silv. plated	0,040/1000	1.000
	l	d ₁	d ₂	s
in mm:	10	0,9	1,8	0,15

Date: 03.01.2019