

Aderendhülsen

0,25 mm² - 15 mm

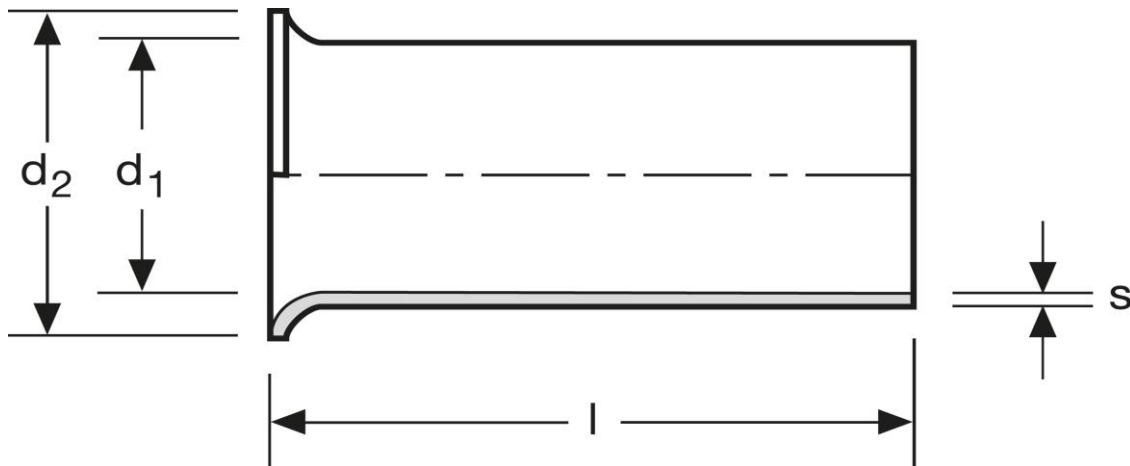

Art.Nr.	Werkstoff	Oberfläche		
A 103151	Cu-ETP	galv. Ag	0,078/1000	1.000
	l	d₁	d₂	s
in mm:	15	0,8	1,7	0,15

Stand: 03.01.2019

Cord end-sleeves

0,25 mm² - 15 mm

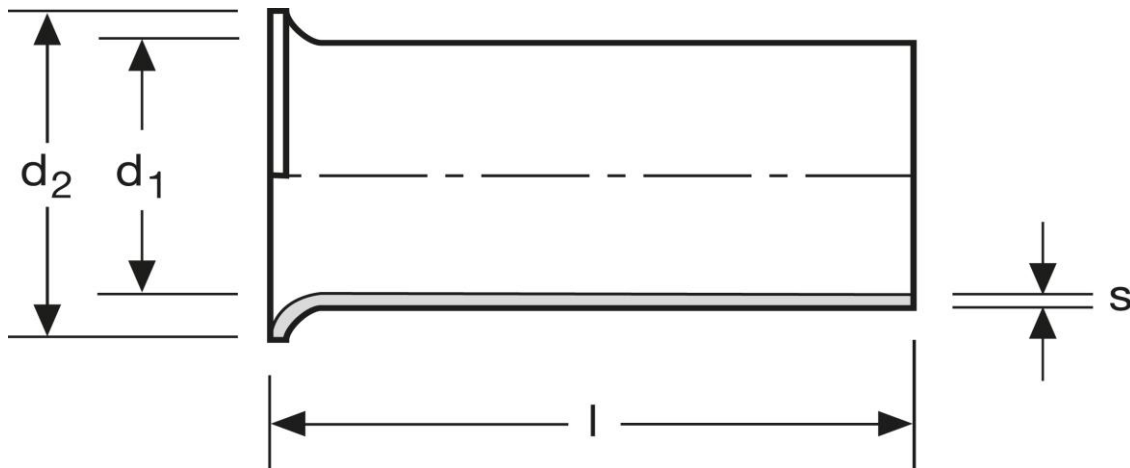

art.no.	material	surface		
A 103151	Cu-ETP	silv. plated	0,078/1000	1.000
	l	d₁	d₂	s
in mm:	15	0,8	1,7	0,15

Date: 03.01.2019