

factory certificate



product:	claw terminals, ring type
art-number:	F 531030.. .. – F 534120.. ..
norm:	DIN 46225 type A and similar
surface:	- bare - tin plated: 3 - 5 µm - fire tin plated: 3 - 5 µm - nickel plated: 3 µm
material:	brass, bronze, steel
information:	RoHS-conform (EU-Direktive 2002/95/EC)

Eisenacher
quality management



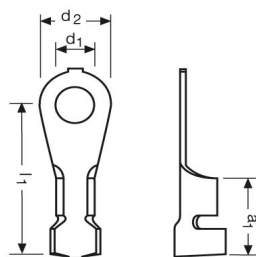

claw terminals – ring type

mm ²	AWG	nominal size	art-number	order code		dimensions				material-thickness	~kg 1000 St.	VE
						l1	a1	d1	d2			
0,5 – 1,0	17	3 – 1	F 531030	18,3	9,0	3,2	8,0	0,6	0,76	2.500
		4 – 1	F 531040	18,3	9,0	4,3	8,0	0,6	0,73	2.000
		5 – 1	F 531050	17,5	9,0	5,3	9,5	0,6	0,76	2.000
		6 – 1	F 531060	22,0	9,0	6,5	12,0	0,6	0,95	1.500
		8 – 1	F 531080	21,0	9,0	8,4	14,0	0,6	1,10	1.250
		10 – 1	F 531100	24,0	9,0	10,5	18,5	0,6	1,48	1.000
1,5 – 2,5	13	3 – 2,5	F 532030	18,3	9,0	3,2	8,0	0,6	0,84	2.000
		4 – 2,5	F 532040	18,3	9,0	4,3	8,0	0,6	0,85	1.500
		5 – 2,5	F 532050	17,5	9,0	5,3	9,5	0,6	0,87	1.500
		6 – 2,5	F 532060	22,0	9,0	6,5	12,0	0,6	1,19	1.250
		8 – 2,5	F 532080	21,0	9,0	8,4	14,0	0,6	1,20	1.000
		10 – 2,5	F 532100	24,0	9,0	10,5	18,5	0,6	1,31	600
4,0 – 6,0	10	4 – 6	F 533040	21,3	11,0	4,3	8,0	0,8	1,65	1.000
		5 – 6	F 533050	20,5	11,0	5,3	9,5	0,8	1,70	1.000
		6 – 6	F 533060	25,0	11,0	6,5	12,0	0,8	2,15	600
		8 – 6	F 533080	24,0	11,0	8,4	14,0	0,8	2,15	600
		10 – 6	F 533100	27,0	11,0	10,5	18,5	0,8	2,27	500
		12 – 6	F 533120	27,0	11,0	13,0	18,5	0,8	2,27	1.000
6 – 10,0	7	6 – 10	F 534060	23,0	12,0	6,5	12,0	1,0	3,60	400
		8 – 10	F 534080	26,4	12,0	8,4	14,0	1,0	3,60	350
		10 – 10	F 534100	28,5	12,0	10,5	18,5	1,0	4,36	250
		12 – 10	F 534120	28,5	12,0	13,0	18,5	1,0	4,36	250
material						surface						
brass				1	1	bare						
bronze				2	2	tin plated						
Stahl				4	3	fire tin plated						
						4 Nickel plated						