

# Werkzeugnis



Produkt: AL-Presskabelschuhe  
für Aluminiumseile nach DIN 48201  
und rundgedrückte Sektorleiter

Oberfläche: blank

Artikel-Nr.: K 3300106 – K 3301320

Werkstoff: Al 99,5

Bemerkung: RoHS-konform (EU-Richtlinie 2002/95/EC)

Eisenacher  
Qualitätsmanagement



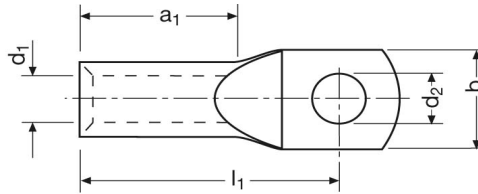

**AL – Presskabelschuhe**

Nennquerschnitt mm <sup>2</sup>		Kenn- ziffer	Nenngröße	Artikel- Nummer	Abmessung (mm)				~kg 1000 St.	VE
rm / sm	se				d1	d2	b	l		
10		10	6 – 10	K 3300106	5,0	6,5	16,0	52,0	9,30	100
			8 – 10	K 3300108	5,0	8,5	18,0	52,0	9,30	100
16	25	12	8 – 16	K 3300208	5,8	8,5	18,0	52,0	13,70	100
			10 – 16	K 3300210	5,8	10,5	18,0	52,0	13,90	100
25	35	12	8 – 25	K 3300308	6,8	8,5	18,0	60,0	13,80	100
			10 – 25	K 3300310	6,8	10,5	18,0	60,0	13,90	100
35	50	14	10 – 35	K 3300410	8,0	10,5	21,0	67,0	20,80	100
			12 – 35	K 3300412	8,0	13,0	21,0	67,0	20,50	100
50	70	16	10 – 50	K 3300510	9,8	10,5	25,0	72,0	28,00	50
			12 – 50	K 3300512	9,8	13,0	25,0	72,0	27,00	50
70	95	18	10 – 70	K 3300610	11,2	10,5	28,0	86,0	44,60	50
			12 – 70	K 3300612	11,2	13,0	28,0	86,0	43,70	50
95	120	22	10 – 95	K 3300710	13,2	10,5	32,0	90,0	67,60	25
			12 – 95	K 3300712	13,2	13,0	32,0	90,0	65,80	25
			16 – 95	K 3300716	13,2	17,0	34,0	90,0	64,70	25
120	150	22	12 – 120	K 3300812	14,7	13,0	32,0	91,0	69,60	25
			16 – 120	K 3300816	14,7	17,0	34,0	91,0	67,40	25
150	185	25	12 – 150	K 3300912	16,3	13,0	35,0	103,0	90,00	25
			16 – 150	K 3300916	16,3	17,0	35,0	103,0	88,00	25
			20 – 150	K 3300920	16,3	21,0	41,0	103,0	89,00	25
185	240	28	12 – 185	K 3301012	18,3	13,0	40,0	106,0	129,00	20
			16 – 185	K 3301016	18,3	17,0	40,0	106,0	127,40	20
			20 – 185	K 3301020	18,3	21,0	40,0	106,0	120,70	20
240	300	32	12 – 240	K 3301112	21,0	13,0	45,0	116,0	173,00	15
			16 – 240	K 3301116	21,0	17,0	45,0	116,0	170,00	15
			20 – 240	K 3301120	21,0	21,0	45,0	116,0	169,50	15
300		34	16 – 300	K 3301216	23,3	17,0	49,0	124,0	200,00	10
			20 – 300	K 3301220	23,3	21,0	49,0	124,0	198,00	10
400		38	16 – 400	K 3301316	26,0	17,0	58,0	165,0	333,00	5
			20 – 400	K 3301320	26,0	21,0	58,0	165,0	414,00	5

rm	=	round stranded
sm	=	sector stranded
se	=	sector solid