

factory certificate



product: tubular cable-lugs
for fine stranded conductors

surface: tin plated: 3 - 5 µm

art-number: K 351050 – K 3633000

material: Cu-ETP tube acc. to EN 13600

information: also available with inspection hole
RoHS-conform (EU-Direktive 2002/95/EC)

Eisenacher
quality management



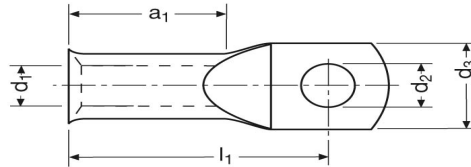

tubular cable-lugs

mm ²	AWG	nominal size	art-number	dimensions					~kg 1000 St.	VE
				d2	d3	l1	a1	d1		
10	7	5 – 10	K 351050	5,5	12,0	26,7	12,6	5,6	7,00	100
		6 – 10	K 351060	6,5	12,0	26,7	12,6	5,6	7,00	100
		8 – 10	K 351080	8,5	15,0	27,7	12,6	5,6	8,50	100
		10 – 10	K 351100	10,5	15,0	27,7	12,6	5,6	8,50	100
		12 – 10	K 351120	13,0	19,0	27,7	12,6	5,6	9,00	100
16	5	6 – 16	K 352060	6,5	13,0	30,6	14,6	6,6	10,00	100
		8 – 16	K 352080	8,4	16,0	30,6	14,6	6,6	11,00	100
		10 – 16	K 352100	10,5	16,0	32,6	14,6	6,6	11,50	100
		12 – 16	K 352120	13,0	17,5	32,6	14,6	6,6	11,50	100
25	3	6 – 25	K 353060	6,5	15,0	34,5	16,5	7,9	17,00	100
		8 – 25	K 353080	8,4	17,0	34,5	16,5	7,9	17,00	100
		10 – 25	K 353100	10,5	17,0	34,5	16,5	7,9	17,00	100
		12 – 25	K 353120	13,0	18,5	34,5	16,5	7,9	18,00	100
35	2	8 – 35	K 354080	8,4	18,0	36,5	18,5	9,2	21,00	25
		10 – 35	K 354100	10,5	18,0	36,5	18,5	9,2	21,00	25
		12 – 35	K 354120	13,0	19,0	36,5	18,5	9,2	23,00	25
		16 – 35	K 354160	17,0	21,0	36,5	18,5	9,2	23,00	25
50	1/0	8 – 50	K 355080	8,4	21,0	45,5	21,5	11,0	31,00	25
		10 – 50	K 355100	10,5	21,0	45,5	21,5	11,0	32,00	25
		12 – 50	K 355120	13,0	21,0	45,5	21,5	11,0	32,00	25
		16 – 50	K 355160	17,0	28,0	45,5	21,5	11,0	33,00	25
70	2/0	8 – 70	K 356080	8,4	24,0	54,0	27,5	13,1	42,00	25
		10 – 70	K 356100	10,5	24,0	54,0	27,5	13,1	41,00	25
		12 – 70	K 356120	13,0	24,0	54,0	27,5	13,1	41,00	25
		16 – 70	K 356160	17,0	24,0	54,0	27,5	13,1	42,00	25
95	3/0	10 – 95	K 357100	10,5	28,0	62,5	32,5	14,5	55,00	25
		12 – 95	K 357120	13,0	28,0	62,5	32,5	14,5	56,00	25
		16 – 95	K 357160	17,0	28,0	62,5	32,5	14,5	56,00	25
		20 – 95	K 357200	21,0	34,0	62,5	32,5	14,5	58,00	25
120	4/0	10 -120	K 358100	10,5	30,0	62,5	31,5	16,2	87,00	25
		12 – 120	K 358120	13,0	30,0	62,5	31,5	16,2	83,00	25
		16 – 120	K 358160	17,0	30,0	62,5	31,5	16,2	82,00	25
		20 – 120	K 358200	21,0	36,0	62,5	31,5	16,2	82,00	25
150	5/0	12 – 150	K 359120	13,0	33,0	71,5	35,5	18,0	100,00	25
		16 – 150	K 359160	17,0	33,0	71,5	35,5	18,0	102,00	25
		20 – 150	K 359200	21,0	33,0	71,5	35,5	18,0	102,00	25
185	6/0	10 – 185	K 3611000	10,5	37,0	76,6	39,6	20,6	124,00	25
		12 – 185	K 3611200	13,0	37,0	76,6	39,6	20,6	121,00	25
		14 – 185	K 3611400	15,0	37,0	76,6	39,9	20,6	121,00	25
		16 – 185	K 3611600	17,0	37,0	76,6	39,6	20,6	125,00	25
		20 – 185	K 3612000	21,0	37,0	76,6	39,6	20,6	122,00	25

240	7/0	10 – 240	K 3621000	10,5	41,0	81,5	41,0	23,0	153,00	25
		12 – 240	K 3621200	13,5	41,0	81,5	41,0	23,0	154,00	25
		14 – 240	K 3621400	15,0	41,0	81,5	41,0	23,0	154,00	25
		16 – 240	K 3621600	17,0	41,0	81,5	41,0	23,0	160,00	25
		20 – 240	K 3622000	21,0	41,0	81,5	41,0	23,0	152,00	25
300	8/0	12 – 300	K 3631200	13,5	47,0	91,0	43,0	26,0	235,00	25
		14 – 300	K 3631400	15,0	47,0	91,0	43,0	26,0	235,00	25
		16 – 300	K 3631600	17,0	47,0	91,0	43,0	26,0	232,00	25
		20 – 300	K 3633000	21,0	47,0	91,0	43,0	26,0	230,00	25