

# factory certificate



product: connectors  
surface: tin plated: 3 - 5 µm  
art-number: KV 332000 – KV 332300  
norm: similar DIN 46267  
material: Cu-ETP tube acc. to EN 13600  
information: RoHS-conform (EU-Direktive 2002/95/EC)

Eisenacher  
quality management



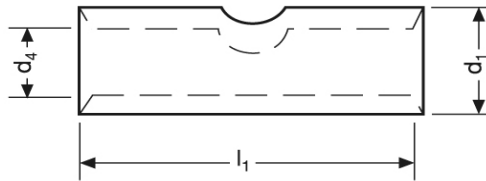

connectors

mm <sup>2</sup>	AWG	nominal size	art-number	dimensions				~kg 1000 St.	VE
				d4	l1	d1	s		
0,75	18	0,75	KV 332000	1,3	20,0	2,8	0,8	0,90	1.000
1,5	15	1,0	KV 332001	1,8	20,0	3,3	0,8	1,35	1.000
2,5	13	2,5	KV 332002	2,3	20,0	4,2	0,8	2,15	1.000
6,0	10	6,0	KV 332006	4,0	30,0	6,0	1,0	6,00	500
10	7	10	KV 332010	5,0	45,0	8,0	1,1	6,00	500
16	5	16	KV 332016	6,0	35,0	9,0	1,2	10,20	500
25	3	25	KV 332025	7,0	45,0	10,0	1,5	14,30	100
35	2	35	KV 332035	8,5	55,0	12,0	1,6	22,50	100
50	1/0	50	KV 332050	10,0	50,5	14,0	1,8	33,80	100
70	2/0	70	KV 332070	12,0	75,0	16,0	2,0	49,00	100
95	3/0	95	KV 332095	13,5	75,0	18,0	2,5	60,00	50
120	4/0	120	KV 332120	15,0	65,0	20,0	3,0	91,00	50
150	5/0	150	KV 332150	17,0	70,0	22,0	3,2	123,00	50
185	6/0	185	KV 332185	19,0	75,0	24,0	3,2	125,00	25
240	7/0	240	KV 332240	21,0	85,0	26,0	3,2	139,00	25
300	8/0	300	KV 332300	24,0	100,0	30,0	3,5	220,00	25